

**Section A**  
**WEAR PLATE**

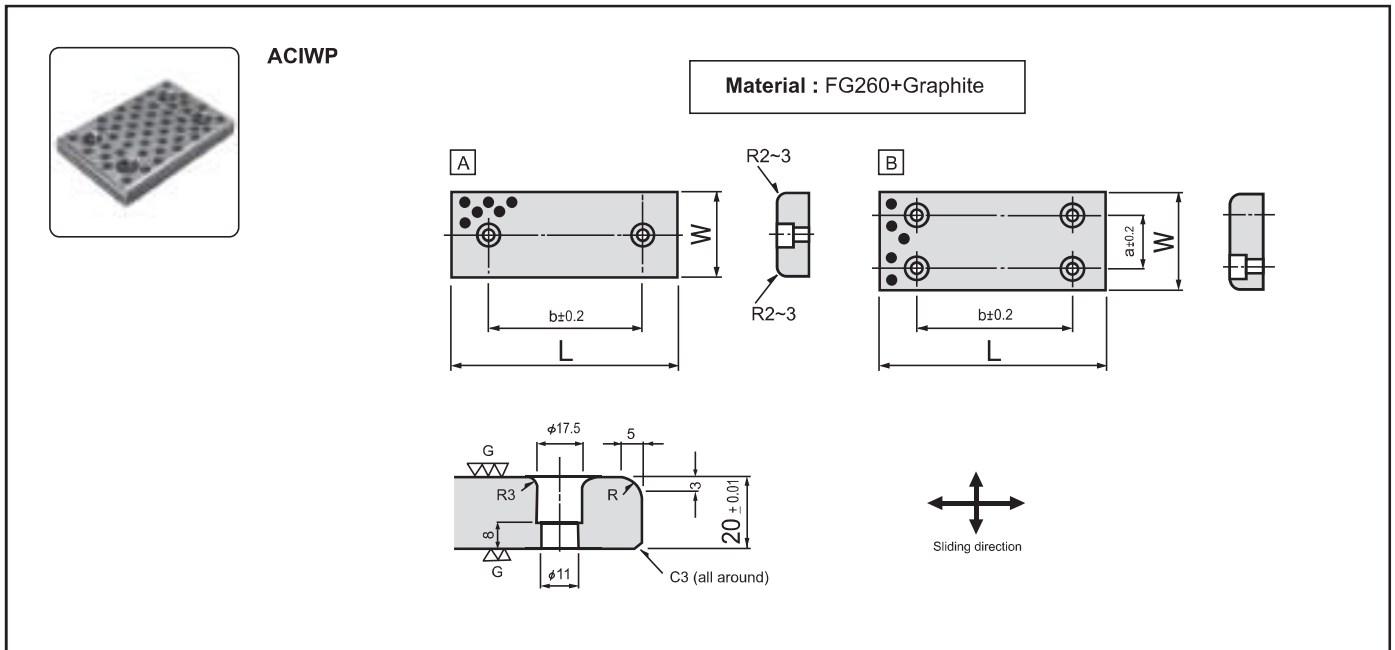

# Oilless Wear Plate

Cast iron (FG260) is used as the base metal with special solid lubricants embedded. The slide plate of this type has excellent wear-resistance. This slide plate as well as ABWP is applicable for most sliding areas of press dies.



Standard No.	W	L	a	b	Sketch
ACIWP- 48X 75	48	75	—	45	A
ACIWP- 48X100		100		50	
ACIWP- 48X125		125		75	
ACIWP- 48X150		150		100	
ACIWP- 48X200		200		150	
ACIWP- 75X 75	75	75	—	25	
ACIWP- 75X100		100		50	
ACIWP- 75X125		125		75	
ACIWP- 75X150		150		100	
ACIWP- 75X200		200		150	
ACIWP- 75X250	250	200	200		
ACIWP- 100X100	100	100	50	50	B
ACIWP- 100X125		125		75	
ACIWP- 100X150		150		100	
ACIWP- 100X200		200		150	
ACIWP- 100X250		250		200	
ACIWP- 100X300	300	200	200		
ACIWP- 125X125	125	125	50	75	
ACIWP- 125X150		150		100	
ACIWP-125X200		200		150	
ACIWP-125X250		250		200	
ACIWP-125X300		300		200	
ACIWP-150X150	150	150	100	100	
ACIWP-150X200		200		150	
ACIWP-150X250		250		200	



ORDERING  
CODE

CATALOG NO.	W	L
ACIWP	100	125

# Oilless Wear Plate

Special copper alloy is used as the base metal with special solid lubricants embedded. The slide plate of this type has excellent wear-resistance. This slide plate as well as ACIWP is applicable for most sliding areas of press dies.

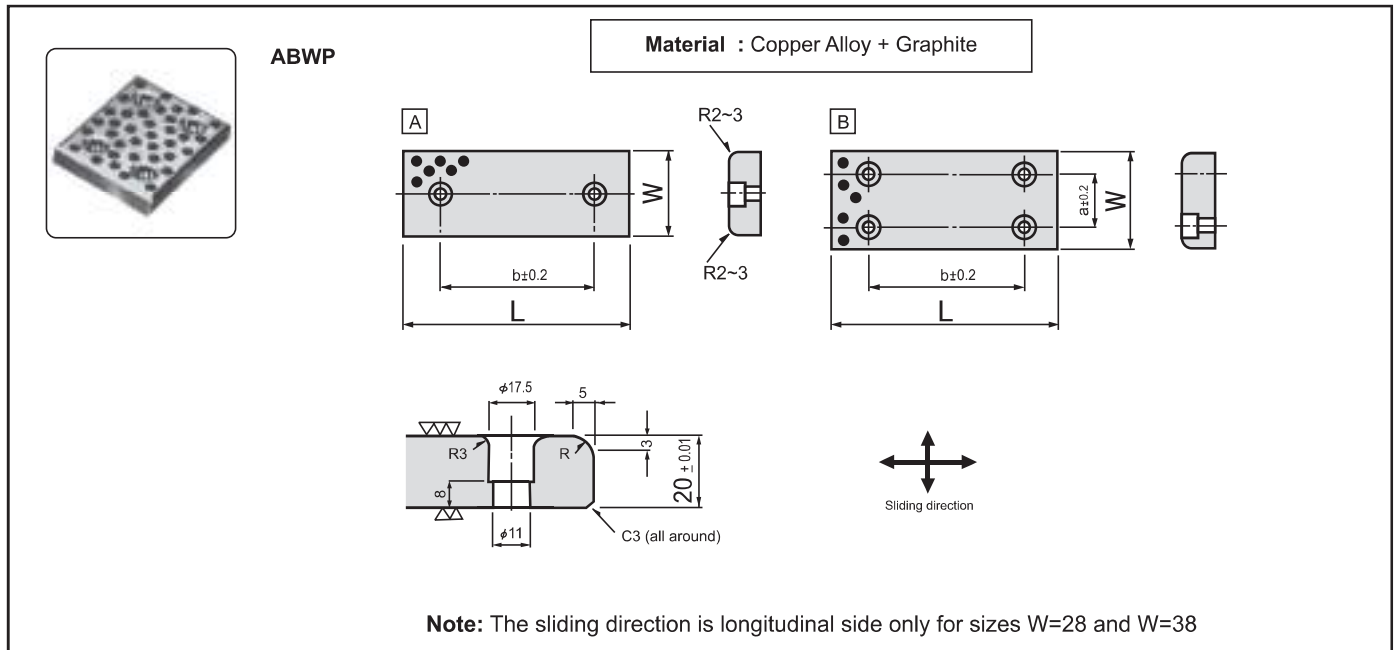

Standard No.	W	L	a	b	Sketch
ABWP- 28X 75	28	75	—	45	A
ABWP- 28X100		100		50	
ABWP- 28X150		150		100	
ABWP- 38X 75	38	75	—	45	
ABWP- 38X100		100		50	
ABWP- 38X150		150		100	
ABWP- 48X 75	48	75	—	45	
ABWP- 48X100		100		50	
ABWP- 48X125		125		75	
ABWP- 48X150		150		100	
ABWP- 48X200		200		150	
ABWP- 58X 75	58	75	—	45	
ABWP- 58X100		100		50	
ABWP- 58X150		150		100	
ABWP- 75X 75	75	75	—	25	
ABWP- 75X100		100		50	
ABWP- 75X125		125		75	
ABWP- 75X150		150		100	
ABWP- 75X200		200		150	
ABWP-100X100	100	100	50	50	B
ABWP-100X125		125		75	
ABWP-100X150		150		100	
ABWP-100X200		200		150	
ABWP-100X250		250		200	
ABWP-100X300		300		200	
ABWP-125X125	125	125	50	75	
ABWP-125X150		150		100	
ABWP-125X200		200		150	
ABWP-125X250		250		200	
ABWP-125X300		300		200	
ABWP-125X350		350		200	
ABWP-150X150	150	150	100	100	
ABWP-150X200		200		150	
ABWP-150X250		250		200	



**ORDERING CODE**

CATALOG NO.	W	L
ABWP	100	125

# Oilless Thin (10mm) Wear Plate

Special copper alloy is used as the base metal with special solid lubricants embedded. The slide plate of this type has good wear-resistance. This thin plate of 10 mm thickness is designed to save space and is applicable for pads, heels or cams in press dies.

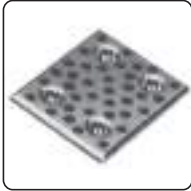

**ABTWP**  
**ASTWP**

**Material :** Copper Alloy + Graphite  
Case Hardened Steel + Graphite

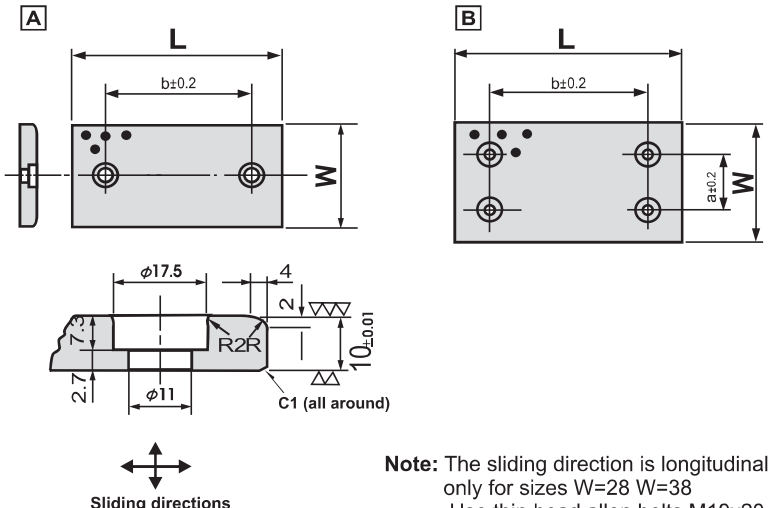

**Note:** The sliding direction is longitudinal side only for sizes W=28 W=38  
Use thin head allen bolts M10x20 for clamping.

Standard No.	W	L	a	b	Sketch
ASTWP- 28X75	28	75	—	45	A
ASTWP- 28X100		100			
ASTWP- 28X125		125			
ASTWP- 28X150		150			
ASTWP- 38X75	38	75	—	45	
ASTWP- 38X100		100			
ASTWP- 38X125		125			
ASTWP- 38X150		150			
ASTWP- 48X75	48	75	—	45	
ASTWP- 48X100		100			
ASTWP- 48X125		125			
ASTWP- 48X150		150			
ASTWP- 48X200		200		150	
ASTWP- 75X75	75	75	—	25	
ASTWP- 75X100		100			
ASTWP- 75X125		125			
ASTWP- 75X150		150			
ASTWP- 75X200		200		150	
ASTWP- 100X100	100	100	50	50	B
ASTWP-100X125		125			
ASTWP-100X150		150			
ASTWP-100X200		200			
ASTWP-100X250		250		200	
ASTWP-125X150	125	150	50	100	
ASTWP-125X200		200			
ASTWP-125X250		250			
ASTWP-150X150	150	150	100	100	
ASTWP-150X200		200			

Standard No.	W	L	a	b	Sketch
ABTWP- 28X75	28	75	—	45	A
ABTWP- 28X100		100			
ABTWP- 28X125		125			
ABTWP- 28X150		150			
ABTWP- 38X75	38	75	—	45	
ABTWP- 38X100		100			
ABTWP- 38X125		125			
ABTWP- 38X150		150			
ABTWP- 48X75	48	75	—	45	
ABTWP- 48X100		100			
ABTWP- 48X125		125			
ABTWP- 48X150		150			
ABTWP- 48X200		200		150	
ABTWP- 75X75	75	75	—	25	
ABTWP- 75X100		100			
ABTWP- 75X125		125			
ABTWP- 75X150		150			
ABTWP- 75X200		200		150	
ABTWP- 100X100	100	100	50	50	B
ABTWP-100X125		125			
ABTWP-100X150		150			
ABTWP-100X200		200			
ABTWP-100X250		250		200	
ABTWP-125X150	125	150	50	100	
ABTWP-125X200		200			
ABTWP-125X250		250			
ABTWP-150X150	150	150	100	100	
ABTWP-150X200		200			



ORDERING CODE

CATALOG NO.	W	L
ABTWP	100	125
ASTWP	100	125

# Oilless Thin (5mm) Wear Plate



**ABUWP**

**Material : Copper Alloy + Graphite**

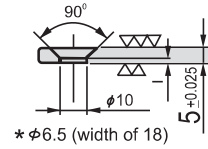
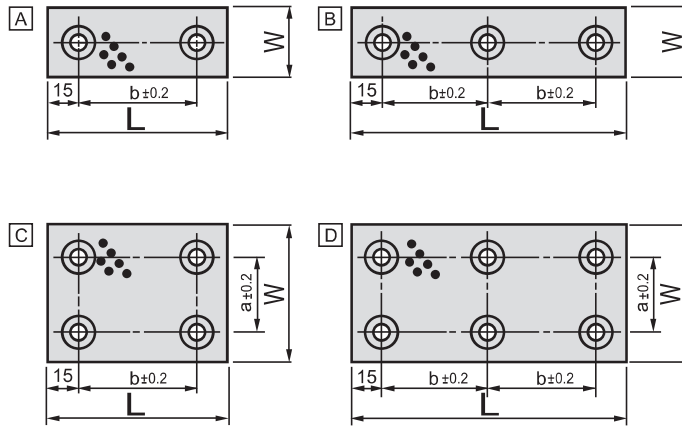

\* φ6.5 (width of 18)



Standard No.	W	L	a	b	Sketch
ABUWP- 18X 50	18	50	—	20	A
ABUWP- 18X 75		75		45	
ABUWP- 18X100		100		70	
ABUWP- 18X150		150		60	B
ABUWP- 28X 50	28	50	—	20	A
ABUWP- 28X 75		75		45	
ABUWP- 28X100		100		70	
ABUWP- 28X150		150		60	B
ABUWP- 38X 50	38	50	—	20	A
ABUWP- 38X 75		75		45	
ABUWP- 38X100		100		70	
ABUWP- 38X150		150		60	B
ABUWP- 48X 75	48	75	—	45	A
ABUWP- 48X100		100		70	
ABUWP- 48X125		125		95	
ABUWP- 48X150		150		60	B
ABUWP- 75X 75	75	75	45	45	C
ABUWP- 75X100		100		70	
ABUWP- 75X125		125		95	
ABUWP- 75X150		150		60	
ABUWP- 100X100	100	100	70	70	C
ABUWP- 100X125		125		95	
ABUWP- 100X150		150		60	D



**ORDERING CODE**

CATALOG NO.	W	L
ABUWP	100	125



# Oilless Wear Plate

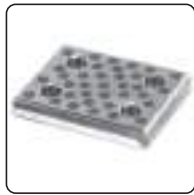

ASWP

<b>Material</b>	Case hardening steel + Graphite
<b>Hardness</b>	56 - 60 Rc

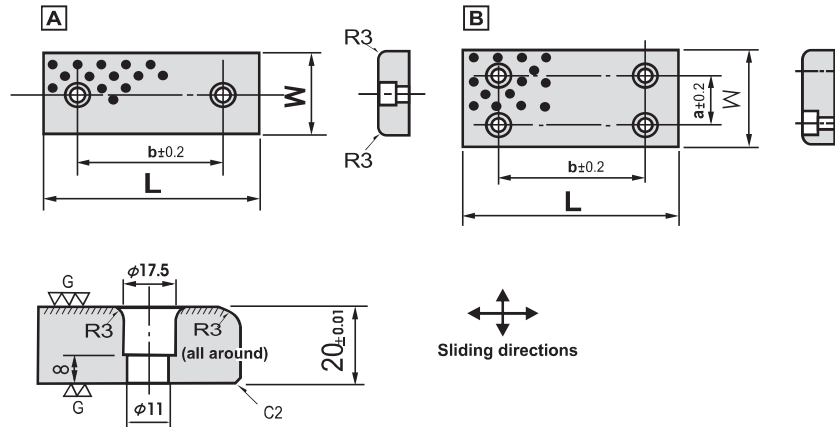

Standard No.	W	L	a	b	Sketch
ASWP- 48X 75	48	75	—	45	A
ASWP- 48X100		100		50	
ASWP- 48X125		125		75	
ASWP- 48X150		150		100	
ASWP- 48X200		200		150	
ASWP- 75X 75	75	75	—	25	A
ASWP- 75X100		100		50	
ASWP- 75X125		125		75	
ASWP- 75X150		150		100	
ASWP- 75X200		200		150	
ASWP- 100X100	100	100	50	50	B
ASWP- 100X125		125		75	
ASWP- 100X150		150		100	
ASWP- 100X200		200		150	
ASWP- 100X250		250		200	
ASWP- 125X125	125	125	50	75	B
ASWP- 125X150		150		100	
ASWP- 125X200		200		150	
ASWP- 125X250		250		200	
ASWP- 150X150	150	150	100	100	B
ASWP- 150X200		200		150	
ASWP- 150X250		250		200	



**ORDERING CODE**

<b>CATALOG NO.</b>	<b>W</b>	<b>L</b>
ASWP	100	125

# Cam Lower Slide Plate



ASCLSP

<b>Material</b>	Case hardening steel
<b>Hardness</b>	56 - 60 Rc

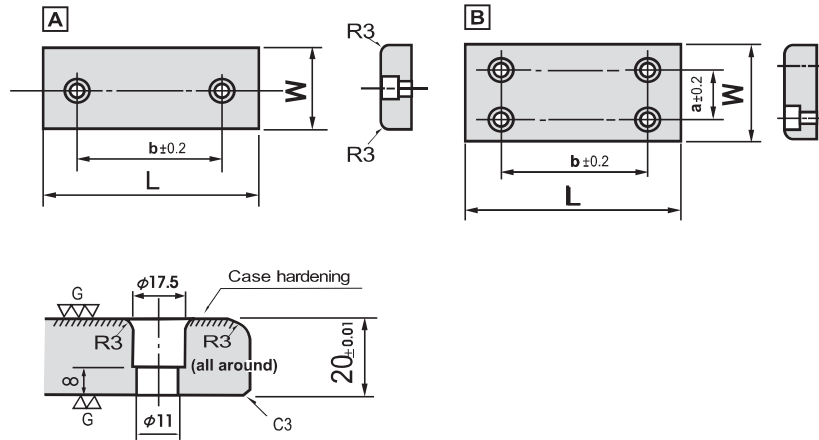

Standard No.	W	L	a	b	Sketch
ASCLSP- 38X 75	38	75	—	45	A
ASCLSP- 38X100		100		50	
ASCLSP- 38X150		150		100	
ASCLSP- 48X 75	48	75	—	45	
ASCLSP- 48X100		100		50	
ASCLSP- 48X125		125		75	
ASCLSP- 48X150		150		100	
ASCLSP- 48X200		200		150	
ASCLSP- 48X250		250		200	
ASCLSP- 75X 75	75	75	—	25	
ASCLSP- 75X100		100		50	
ASCLSP- 75X125		125		75	
ASCLSP- 75X150		150		100	
ASCLSP- 75X200		200		150	
ASCLSP- 75X250				250	
ASCLSP- 100X100	100	100	50	50	B
ASCLSP- 100X125		125		75	
ASCLSP- 100X150		150		100	
ASCLSP- 100X200		200		150	
ASCLSP-100X250				250	
ASCLSP-125X125	125	125	50	75	
ASCLSP-125X150		150		100	
ASCLSP-125X200		200		150	
ASCLSP-125X250				250	
ASCLSP-150X150	150	150	100	100	
ASCLSP-150X200		200		150	
ASCLSP-150X250				250	



ORDERING  
CODE

CATALOG NO.	W	L
ASCLSP	100	125

# Oilless Cam Upper Plate

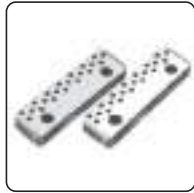

ABCUP  
ACICUP  
ASCUP

Material	ABCUP	Copper Alloy + Graphite
	ACICUP	FG 260 + Graphite
	ASCUP	Case hardening steel + Graphite (HRC 56 - 60 Rc)

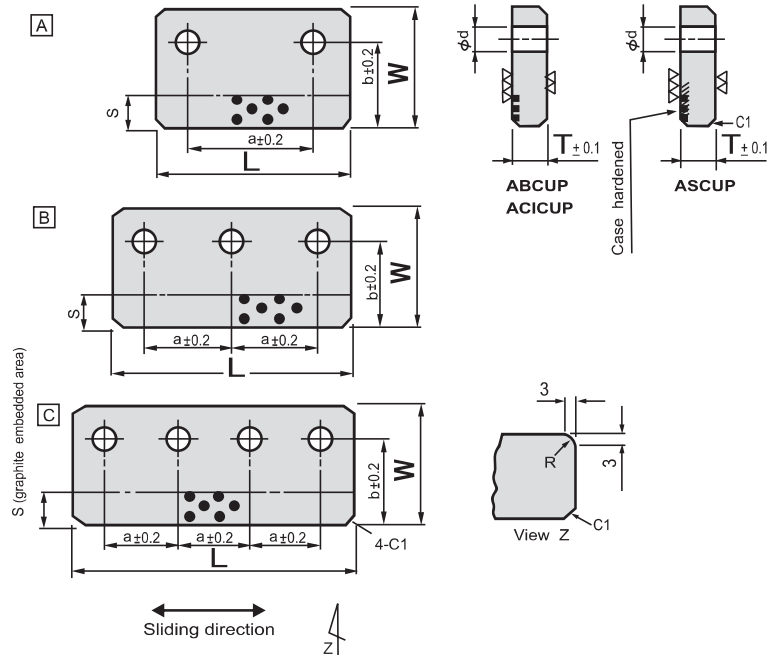

Standard No.	W	L	T	a	b	φd	s	Sketch
ABCUP- 70X160	70	160	25	110	50	18	25	A
ABCUP- 70X200		200		75				B
ABCUP- 70X240		240		90				
ABCUP- 85X200	85	200	28	75	60	22	30	B
ABCUP- 85X240		240		90				
ABCUP- 85X300		300		80			C	
ABCUP- 85X350		350		90				
ACICUP- 70X160	70	160	25	110	50	18	25	A
ACICUP- 70X200		200		75				B
ACICUP- 70X240		240		90				
ACICUP- 85X200	85	200	28	75	60	22	30	B
ACICUP- 85X240		240		90				
ACICUP- 85X300		300		80			C	
ACICUP- 85X350		350		90				
ACICUP- 100X200	100	200	28	75	70	22	30	B
ACICUP- 100X240		240		90				
ACICUP- 100X300		300		80			C	
ACICUP- 100X350		350		90				
ASCUP- 70X160	70	160	25	110	50	18	25	A
ASCUP- 70X200		200		75				B
ASCUP- 70X240		240		90				
ASCUP- 85X200	85	200	28	75	60	22	30	B
ASCUP- 85X240		240		90				
ASCUP- 85X300		300		80			C	
ASCUP- 85X350		350		90				
ASCUP-100X200	100	200	28	75	70	22	30	B
ASCUP-100X240		240		90				
ASCUP-100X300		300		80			C	
ASCUP-100X350		350		90				



ORDERING  
CODE

CATALOG NO.	W	L
ABCUP	70	160
ACICUP	70	160
ASCUP	70	160



# Oilless Cam Upper Plate



**ABMCUP  
ACIMCUP**

<b>Material</b>	ABMCUP	Copper Alloy + Graphite
	ACIMCUP	FG 260 + Graphite

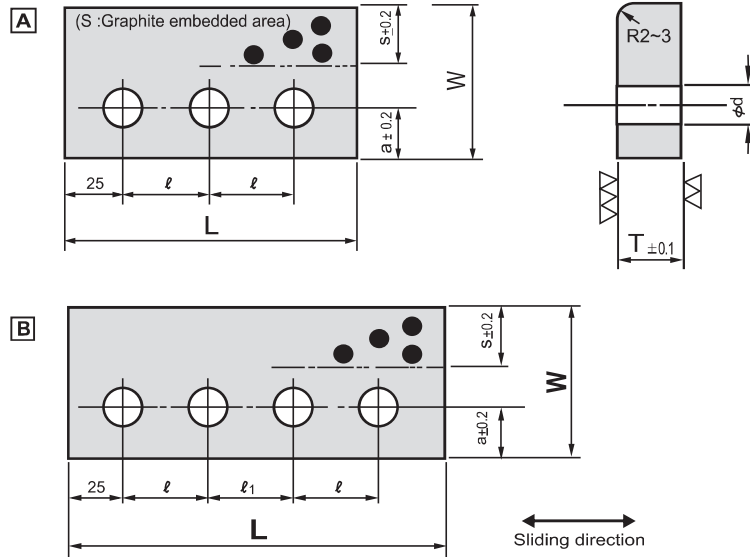

Standard No.	T	L	W	l	l1	a	s	φd	Sketch
ABMCUP- 20X150	20	150	52	50	—	20	12	13	A
ABMCUP- 20X200		200		75					B
ABMCUP- 20X250		250		50					B
ABMCUP- 30X150	30	150	72	50	—	22	—	—	A
ABMCUP- 30X200		200		75					B
ABMCUP- 30X250		250		50					B
ABMCUP- 35X150	35	150	77	50	—	25	27	—	A
ABMCUP- 35X200		200		75					B
ABMCUP- 35X250		250		50					B
ABMCUP- 40X150	40	150	82	50	—	32	—	18	A
ABMCUP- 40X200		200		75					B
ABMCUP- 40X250		250		50					B
ABMCUP- 40X150D		150	105	—	—	—	—	—	A
ABMCUP- 40X200D		200		50					B
ABMCUP- 40X250D		250		75					B
ACIMCUP- 20X150	20	150	52	50	—	20	12	13	A
ACIMCUP- 20X200		200		75					B
ACIMCUP- 20X250		250		50					B
ACIMCUP- 30X150	30	150	72	50	—	22	—	—	A
ACIMCUP- 30X200		200		75					B
ACIMCUP- 30X250		250		50					B
ACIMCUP- 35X150	35	150	77	50	—	25	27	—	A
ACIMCUP- 35X200		200		75					B
ACIMCUP- 35X250		250		50					B
ACIMCUP- 40X150	40	150	82	50	—	32	—	18	A
ACIMCUP- 40X200		200		75					B
ACIMCUP- 40X250		250		50					B
ACIMCUP- 40X150D		150	105	—	—	—	—	—	A
ACIMCUP- 40X200D		200		50					B
ACIMCUP- 40X250D		250		75					B



<b>ORDERING CODE</b>	<b>CATALOG NO.</b>	<b>W</b>	<b>L</b>
	ABMCUP	52	150
	ACIMCUP	52	150

# Oilless Cam Side Block

Cast iron is used as the base metal. Use this block together with ABMCUP or ACIMCUP

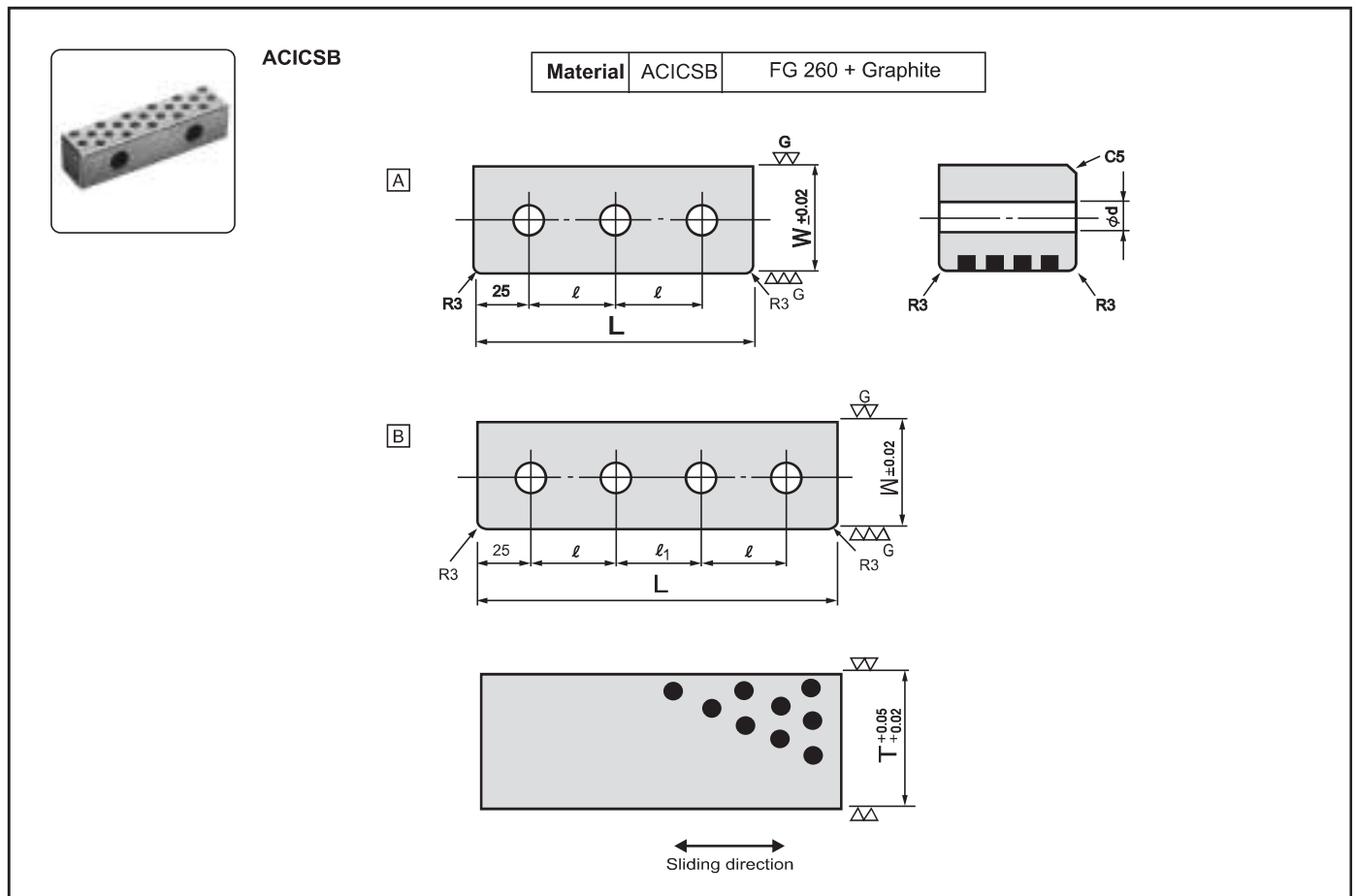

Standard No.	T	L	W	ℓ	ℓ1	φd	Sketch
ACICSB- 40X150	40	150	40	50	—	14	A
ACICSB- 40X200		200		75	—		B
ACICSB- 40X250		250		50	50		—
ACICSB- 55X150	55	150	50	50	—	20	A
ACICSB- 55X200		200		75	—		B
ACICSB- 55X250		250		50	50		—
ACICSB- 70X150	70	150	50	50	—	20	A
ACICSB- 70X200		200		75	—		B
ACICSB- 70X250		250		50	50		—
ACICSB- 30X150	30	150	40	50	—	14	A
ACICSB- 30X200		200		75	—		B
ACICSB- 30X250		250		50	50		—
ACICSB- 45X150	45	150	50	50	—	20	A
ACICSB- 45X200		200		75	—		B
ACICSB- 45X250		250		50	50		—
ACICSB- 60X150	60	150	50	50	—	20	A
ACICSB- 60X200		200		75	—		B
ACICSB- 60X250		250		50	50		—



**ORDERING CODE**

<b>CATALOG NO.</b>	<b>W</b>	<b>L</b>
ACICSB	40	150

# Oilless Cam Side Block

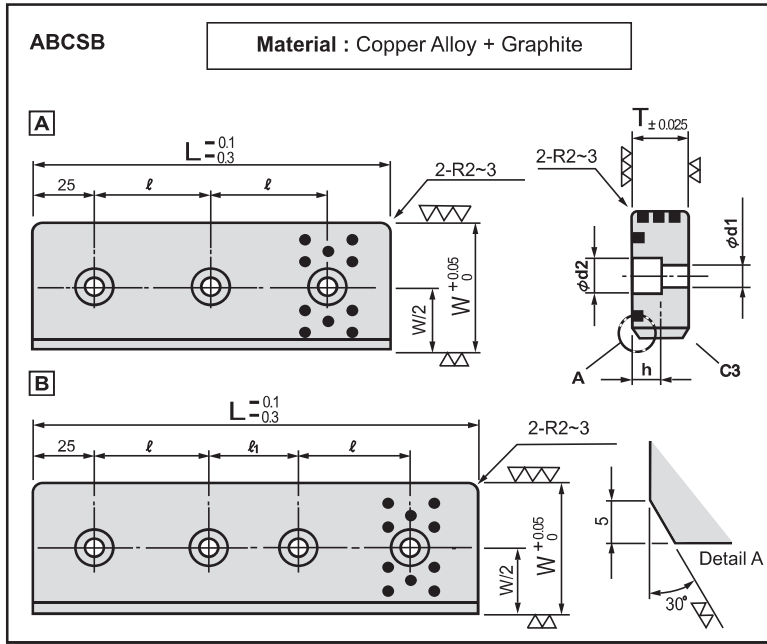

Standard No.	T	W	L	$\ell$	$\ell_1$	Sketch	$\phi d1$	$\phi d2$	h
ABCSB- 50X150X20	20	50	150	50	—	A	11	17.5	12
ABCSB- 50X200X20			200	75	—	B			
ABCSB- 50X250X20			250	75	50	B			
ABCSB- 75X150X20		75	150	50	—	A			
ABCSB- 75X200X20			200	75	—	A			
ABCSB- 75X250X20			250	75	50	B			
ABCSB- 50X150X35	35	50	150	50	—	A	13	20	15
ABCSB- 50X200X35			200	75	—	B			
ABCSB- 50X250X35			250	75	50	B			
ABCSB- 75X150X35		75	150	50	—	A			
ABCSB- 75X200X35			200	75	—	A			
ABCSB- 75X250X35			250	75	50	B			



ORDERING  
CODE

CATALOG NO.	W	L	T
ABCSB	50	150	20

# Cam upper plate

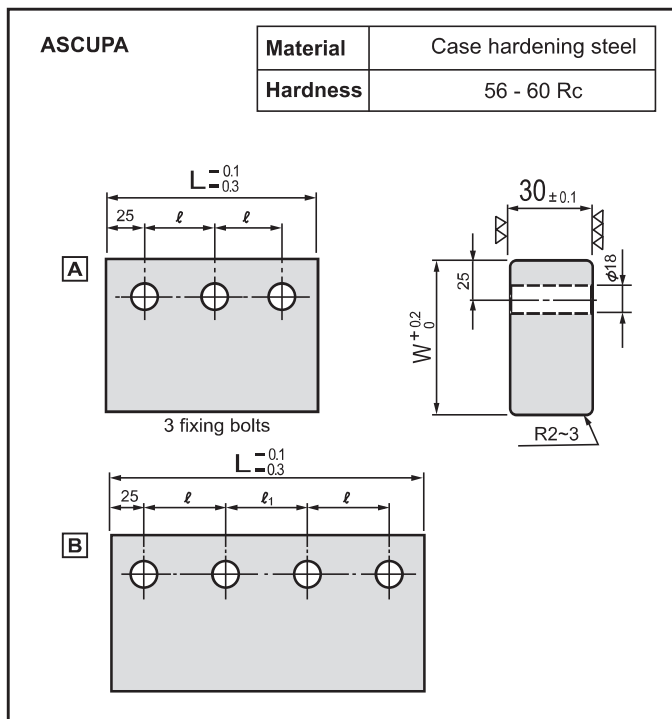

Standard No.	W	L	$\ell$	$\ell_1$	Sketch
ASCUPA- 67X150	67	150	50	—	A
ASCUPA- 67X200		200	75	—	B
ASCUPA- 67X250		250	75	50	B
ASCUPA- 82X150	82	150	50	—	A
ASCUPA- 82X200		200	75	—	A
ASCUPA- 82X250		250	75	50	B



ORDERING  
CODE

CATALOG NO.	W	L
ASCUPA	67	200

# Oilless Mini Slide Plate



ACIMSP

Material : FG260 + Graphite

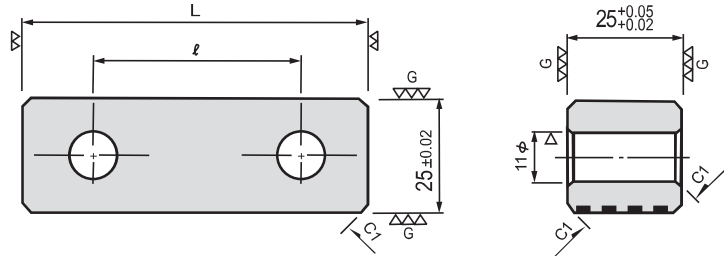

Standard No.	L	ℓ
ACIMSP-25x 75	75	45
ACIMSP-25x100	100	50
ACIMSP-25x125	125	75
ACIMSP-25x150	150	100



ORDERING CODE

CATALOG NO.	L
ACIMSP 25	100

# Oilless mini upper plate



ABMUP

Material : Copper Alloy + Graphite

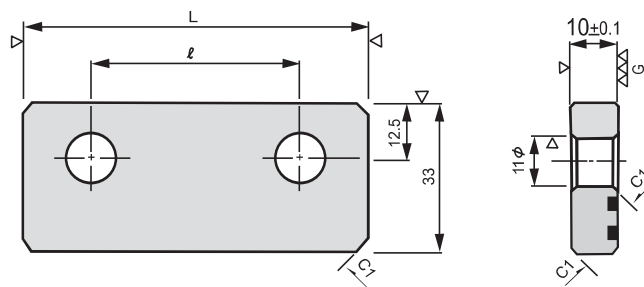

Standard No.	L	ℓ
ABMUP- 33X 75	75	45
ABMUP- 33X100	100	50
ABMUP- 33X125	125	75
ABMUP- 33X150	150	100



ORDERING CODE

CATALOG NO.	L
ABMUP33	100

# Oilless Cam Stroke Plate

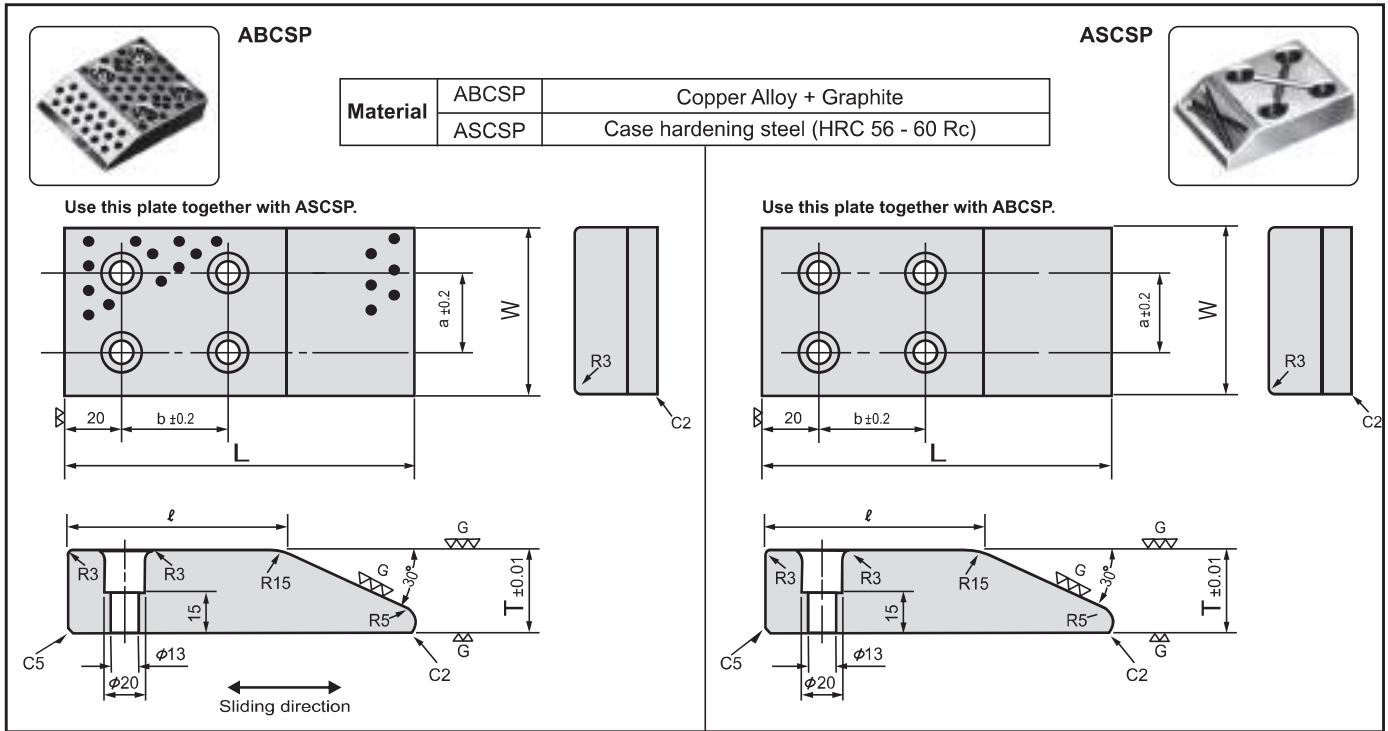

Standard No.	W	L	T	ℓ	a	b
ABCSP- 75X 130	75	130	30	95	40	50
ABCSP- 75X 150		150	45	90		45
ABCSP- 75X 170		170	60	120		75
ABCSP- 75X 200		200				
ABCSP- 100X 130	100	130	30	95	60	50
ABCSP- 100X 150		150	45	90		45
ABCSP- 100X 170		170	60	120		75
ABCSP- 100X 200		200				
ABCSP- 125X 130	125	130	30	95	85	50
ABCSP-125X 150		150	45	90		45
ABCSP-125X 170		170	60	120		75
ABCSP-125X 200		200				
ABCSP-150X 130	150	130	30	95	110	50
ABCSP-150X 150		150	45	90		45
ABCSP-150X 170		170	60	120		75
ABCSP-150X 200		200				
ASCSP- 75X130	75	130	30	95	40	50
ASCSP- 75X150		150	45	90		45
ASCSP- 75X170		170	60	120		75
ASCSP- 75X200		200				
ASCSP- 100X130	100	130	30	95	60	50
ASCSP- 100X150		150	45	90		45
ASCSP- 100X170		170	60	120		75
ASCSP- 100X200		200				
ASCSP- 125X130	125	130	30	95	85	50
ASCSP- 125X150		150	45	90		45
ASCSP- 125X170		170	60	120		75
ASCSP- 125X200		200				
ASCSP- 150X130	150	130	30	95	110	50
ASCSP- 150X150		150	45	90		45
ASCSP- 150X170		170	60	120		75
ASCSP- 150X200		200				



**ORDERING CODE**

CATALOG NO.	W	L	T
ABCSP	100	150	45
ASCSP	100	150	45

# Oilless Cam Stroke Plate (15° type)



**ABCSP-S**



**ASCSP-S**

Material	ABCSP-S	Copper Alloy + Graphite
	ASCSP-S	Case hardening steel (56-60 Rc)

Use this plate together with ASCSP-S for short stroke cam.

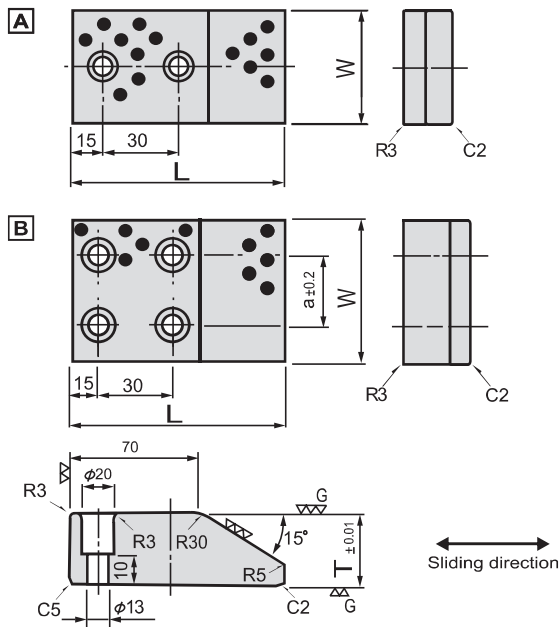

Use this plate together with ABCSP-S for short stroke cam.

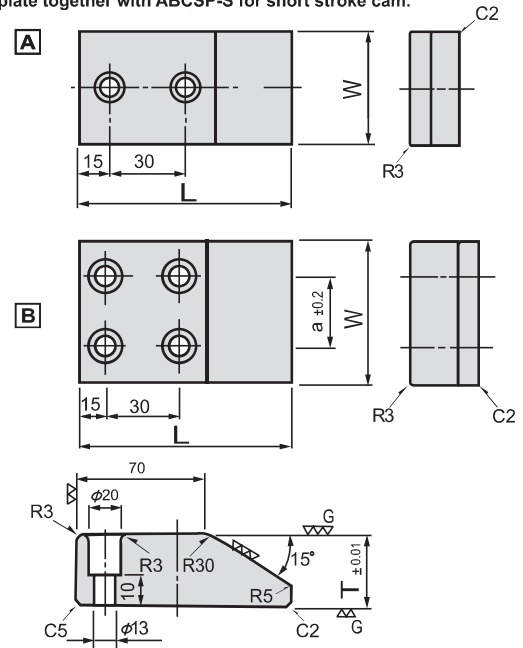

Standard No.	W	L	T	a	Sketch
ABCSP-S- 50X110	50	110	25	—	A
ABCSP-S- 50X130		130	30		
ABCSP-S- 50X150		150	35		
ABCSP-S- 75X110	75	110	25	40	B
ABCSP-S- 75X130		130	30		
ABCSP-S- 75X150		150	35		
ABCSP-S- 100X110	100	110	25	60	B
ABCSP-S- 100X130		130	30		
ABCSP-S- 100X150		150	35		
ASCSP-S- 50X110	50	110	25	—	A
ASCSP-S- 50X130		130	30		
ASCSP-S- 50X150		150	35		
ASCSP-S- 75X110	75	110	25	40	B
ASCSP-S- 75X130		130	30		
ASCSP-S- 75X150		150	35		
ASCSP-S- 100X110	100	110	25	60	B
ASCSP-S- 100X130		130	30		
ASCSP-S- 100X150		150	35		



ORDERING CODE

CATALOG NO.	W	L	T
ABCSP-S	100	150	35
ASCSP-S	100	150	35

# Oilless Cam Bottom Guide Plate

The plate is used to guide the cam slider. This guide plate improves the horizontal centripetal force of the cam slider. Use this guide plate together with ASCBSP series.



**ABCBGP**  
**ABCBGP-B1**

**Material : Copper Alloy + Graphite**

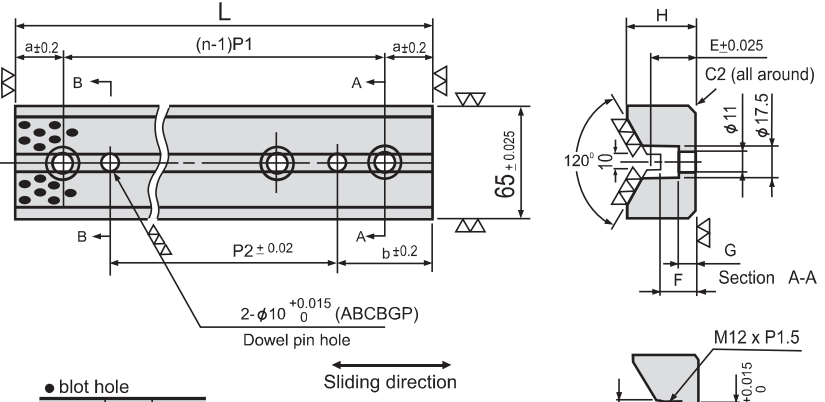

2-φ10<sup>+0.015</sup><sub>0</sub> (ABCBGP)  
Dowel pin hole

• blot hole

W	d	D
35	9	14
50.65	11	17.5

Standard No.	L	H	E	F	G	a	p1	Bolt n	b	p2	
ABCBGP- 100	100	35	18	15	8	20	60	2	40	20	
ABCBGP- 150	150							3			50
ABCBGP- 200	200							4			
ABCBGP- 250	250							5			
ABCBGP- 300	300							6			
ABCBGP-B1- 100	100	37	20	20	10	20	60	2	40	20	
ABCBGP-B1- 125	125										75
ABCBGP-B1- 150	150							100			
ABCBGP-B1- 200	200							75			50
ABCBGP-B1- 250	250							100			
ABCBGP-B1- 300	300							125			

H	a	b	P	P1	No of Bolt Holes n	e	P2	E	F	G	J	Catalog No.	W	L		
24	15	30	45	-	2	8	15	15	4	11			35	75		
			60											100		
	85	125														
	110	150														
	150															
31	15	30	45	-		2	8	15	15	15					50	75
			60													100
	75	125														
	100	150														



ORDERING CODE

CATALOG NO.	L
ABCBGP	150
ABCBGP-B1	150

# Cam Bottom Slide Plate



**ASCBSB  
ASCBSB-B1**

<b>Material</b>	Case Hardening Steel
<b>Hardness</b>	56 - 60 Rc

### Example

Use this plate together ABCBGP series.

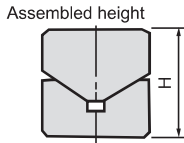

Assembled height of ABCBGP and ASCBSB to be  $H=65$ .  
Assembled height of ABCBGP-B1 and  
ASCBSB-B1 to be  $H=50$ .

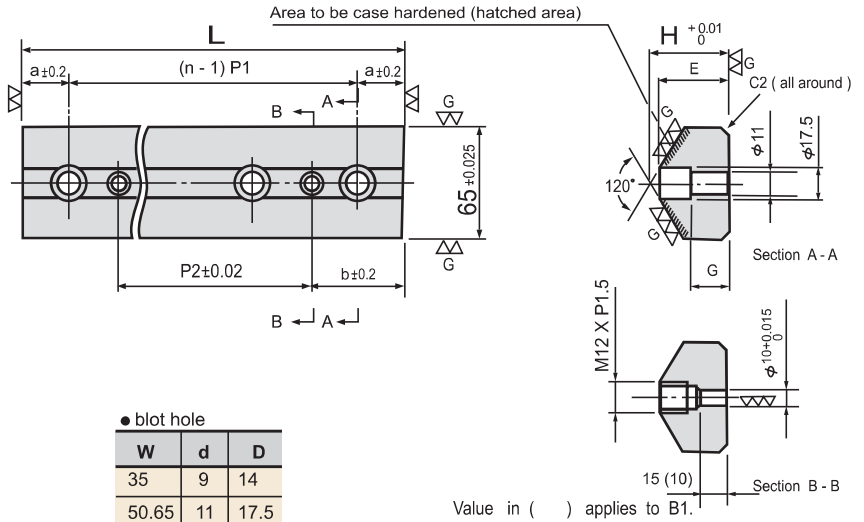

• blot hole

W	d	D
35	9	14
50.65	11	17.5

Standard No.	L	H	E	G	a	p1	Bolt n	b	p2
ASCBSB- 100	100	47	44	20	20	60	2	40	20
ASCBSB- 150	150				25	50	3	50	
ASCBSB- 200	200				4	50			
ASCBSB- 250	250				5	150			
ASCBSB- 300	300				6	200			
ASCBSB-B1- 100	100	30	26	10	20	60	2	40	20
ASCBSB-B1- 125	125				25	75		25	25
ASCBSB-B1- 150	150				100	50			
ASCBSB-B1- 200	200				75	100	3	50	
ASCBSB-B1- 250	250				100	150			
ASCBSB-B1- 300	300				125	200			

H	a	b	P	P1	No of Bolt Holes n	e	P2	E	G	Catalog No.	W	L	
24	15	30	45	-	2	8	15	17	4	CBSP	35	75	
												100	
	20	40	85									125	
												150	
												175	
31	15	30	45	-	2	8	15	29	10		CBSP	50	75
													100
	20	40	60										125
													150
													175
25	50	100	150										



ORDERING CODE

CATALOG NO.	L
ASCBSB	150
ASCBSB-B1	150





# Oilless Cam Bottom Guide Plate

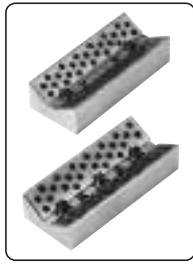

ACBS

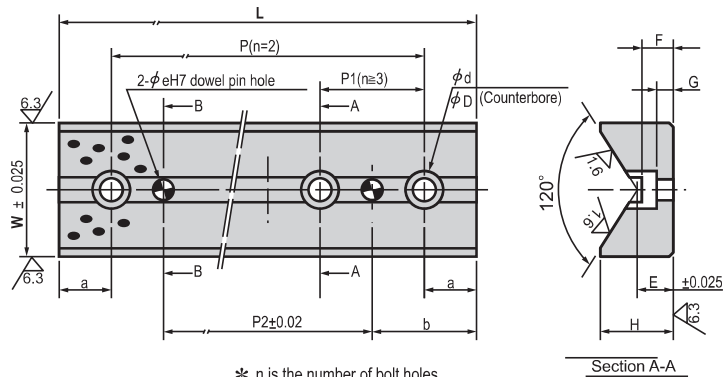

\* n is the number of bolt holes.

Sliding direction

• bolt hole

W	d	D
35	9	14
50	11	17.5

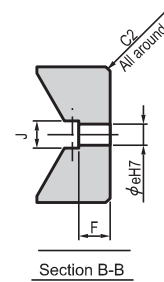

Material : Copper alloy with Graphite

H	a	b	P	P1	No of Bolt Holes n	e	P2	E	F	G	J	Catalog No.	W	L			
24	15	30	45	-	2	8	15	15	4	11	ACBS	35	75				
			60										100				
	85	125															
	110	150															
31	15	30	45	-			2	10	15	18			8	13	ACBS	50	75
			60														100
	75	125															
	100	150															



ORDERING CODE	CATALOG NO.	W	L
ACBS		35	125

# Bottom Slide Plate

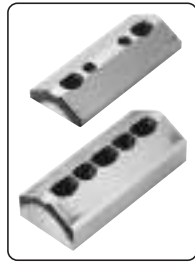

**ACBSP**

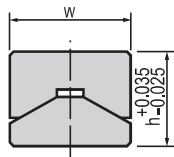
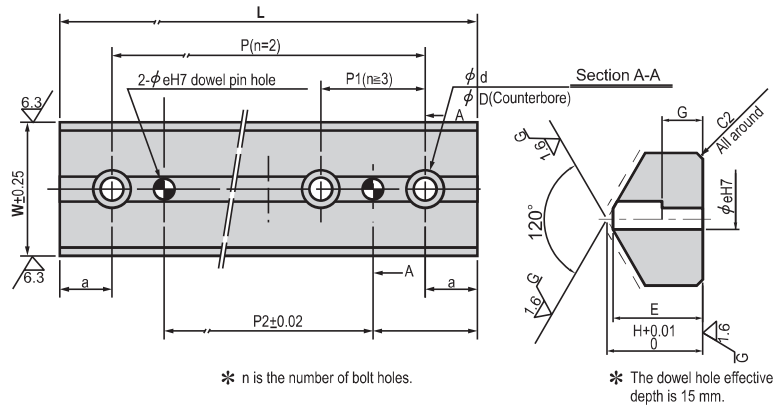

● Total height of combination ACBS and ACBSP

W	D
35	35
50	50

● bolt hole

W	d	D
35	9	14
50	11	17.5

\* --- area  
Area to be Case Hardened  
Material : Case Hardening Steel : HRC55 or more

H	a	b	P	P1	No of Bolt Holes n	e	P2	E	G	Catalog No.	W	L
20	15	30	45	-	2	8	15	17	4	ACBSP	35	75
			60									100
	20	40	85									125
			110									150
			32									15
20	40	60		100								
25	50	75		125								
		100		150								



ORDERING CODE	CATALOG NO.	W	L
ACBSP		35	125

# Oiless Cam Center Guide Block

This plate is used to guide the cam slider in the center. This guide block is applicable for large cam sliders.

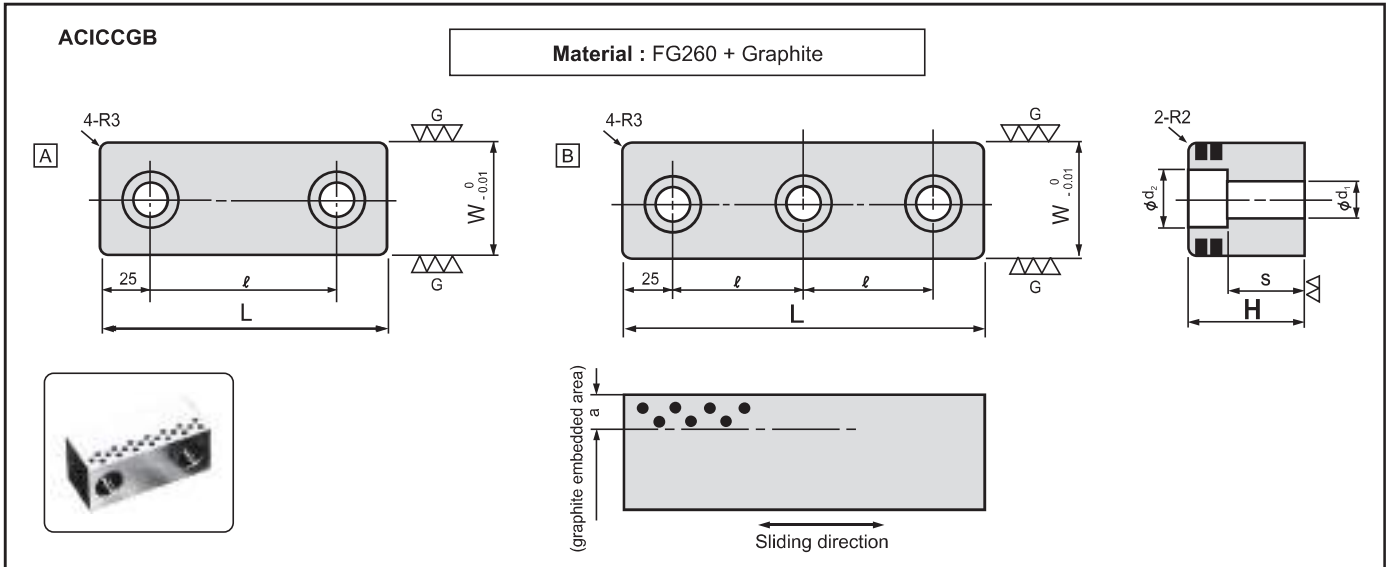

Standard No.	W	H	L	l	a	φ d1	φ d2	s	Sketch
ACICCGB- 40X150	40	45	150	100	15	13	20	30	A
ACICCGB- 40X200			200	150					
ACICCGB- 40X250			250	100					
ACICCGB- 60X150	60	60	150	100	20	18	32	38	A
ACICCGB- 60X200			200	150					
ACICCGB- 60X250			250	100					
ACICCGB- 60X300			300	125					B



**ORDERING CODE**

CATALOG NO. W L  
ACICCGB 40 200

# Oiless cam pad guide plate

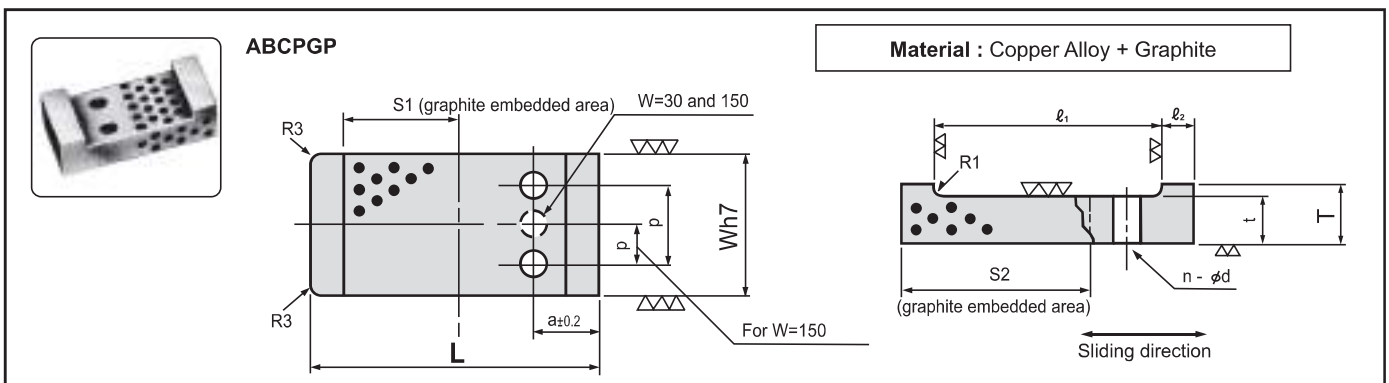

Standard No.	Wh7	L	T	l1	l2	t	s1	s2	p	a	n	φ d	
ABCPGP- 30X 70	30	0	70	17	50	10	12	30	40	—	20	1	11
ABCPGP- 30X 90		-0.021	90		70			50	60				
ABCPGP- 60X120	60	0	120	35	80	20	25	40	60	30	40	2	13
ABCPGP- 60X140			140		100			60	80				
ABCPGP- 60X160			160		120			80	100				
ABCPGP- 100X120	100	-0.030	120	35	80	20	25	40	60	70	40	2	13
ABCPGP- 100X140			140		100			60	80				
ABCPGP- 100X160			160		120			80	100				
ABCPGP- 150X120	150	-0.040	120	35	80	20	25	40	60	60	40	3	18
ABCPGP- 150X140			140		100			60	80				
ABCPGP- 150X160			160		120			80	100				
ABCPGP- 150X180			180		140			100	120				



**ORDERING CODE**

CATALOG NO. W L  
ABCPGP 30 90

# Oilless Cam Pad Guide Plate

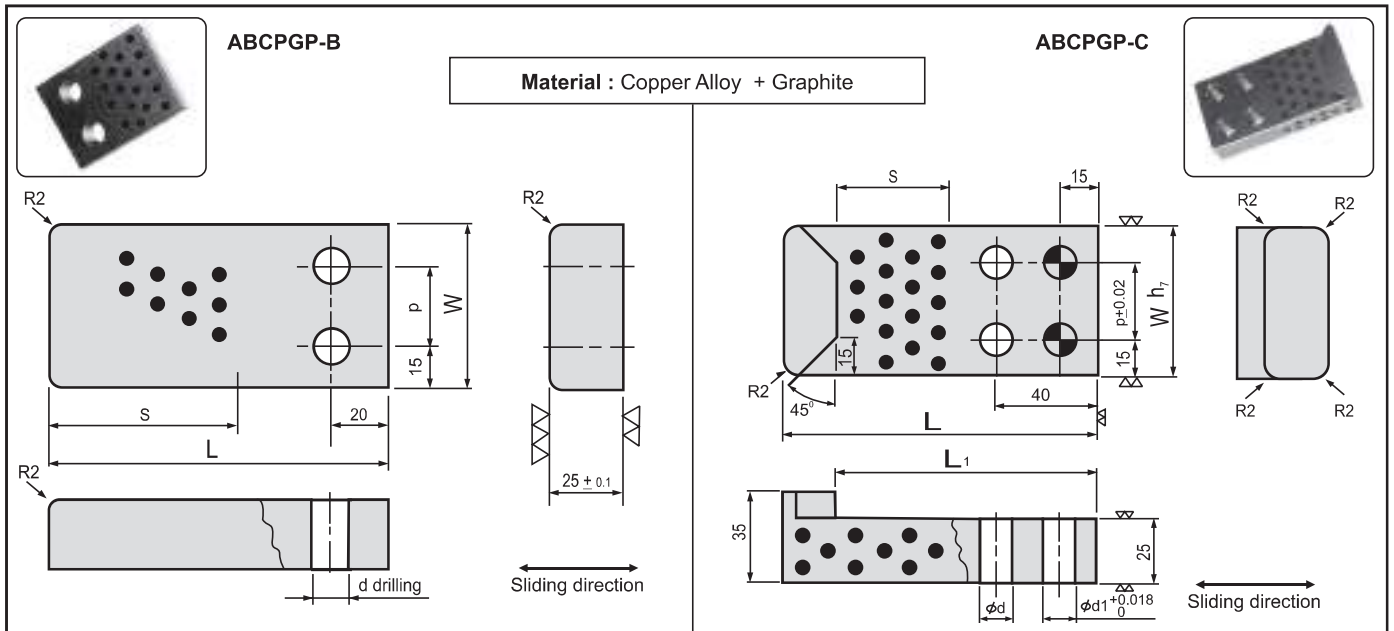

Standard No.	W	L	s	p	φ d
ABCPGP-B- 60X 80	60	80	40	30	13
ABCPGP-B- 60X100		100	60		
ABCPGP-B- 60X120		120	80		
ABCPGP-B- 100X 80	100	80	40	70	18
ABCPGP-B- 100X100		100	60		
ABCPGP-B- 100X120		120	80		
ABCPGP-B- 150X 80	150	80	40	120	18
ABCPGP-B- 150X100		100	60		
ABCPGP-B- 150X120		120	80		

Standard No.	Wh7	L	L1	s	p	φ d	φ d1	
ABCPGP-C- 60X120	0	120	100	40	30	13	13	
ABCPGP-C- 60X140	-0.030	140	120	60				
ABCPGP-C- 60X160		160	140	80				
ABCPGP-C- 100X120	0	120	100	40	70	18	18	
ABCPGP-C- 100X140		-0.035	140	120				60
ABCPGP-C- 100X160			160	140				80
ABCPGP-C- 150X120	0	120	100	40	120	18	18	
ABCPGP-C- 150X140		-0.040	140	120				60
ABCPGP-C- 150X160			160	140				80

ORDERING CODE: CATLOG NO. W L  
ABCPGP-B 60 100

ORDERING CODE: CATLOG NO. W L  
ABCPGP-C 60 120

## Cam positive return piece

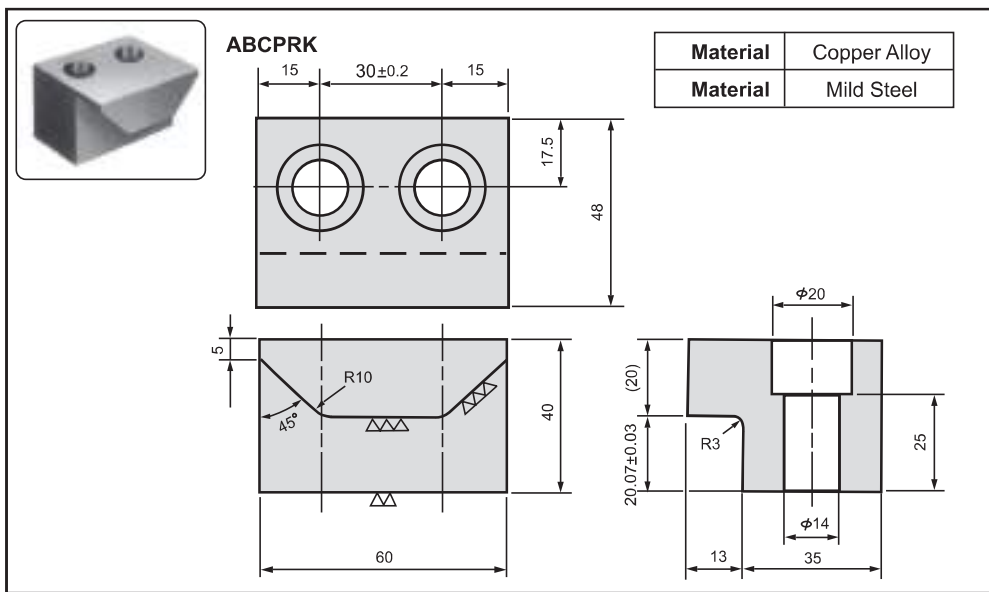

Standard No.	Material
ABCPRK -40-W	Copper Alloy
ABCPRK -40-S	Mild Steel

ORDERING CODE: CATLOG NO.  
ABCPRK-40-W



# Oilless Cam Positive Return Plate

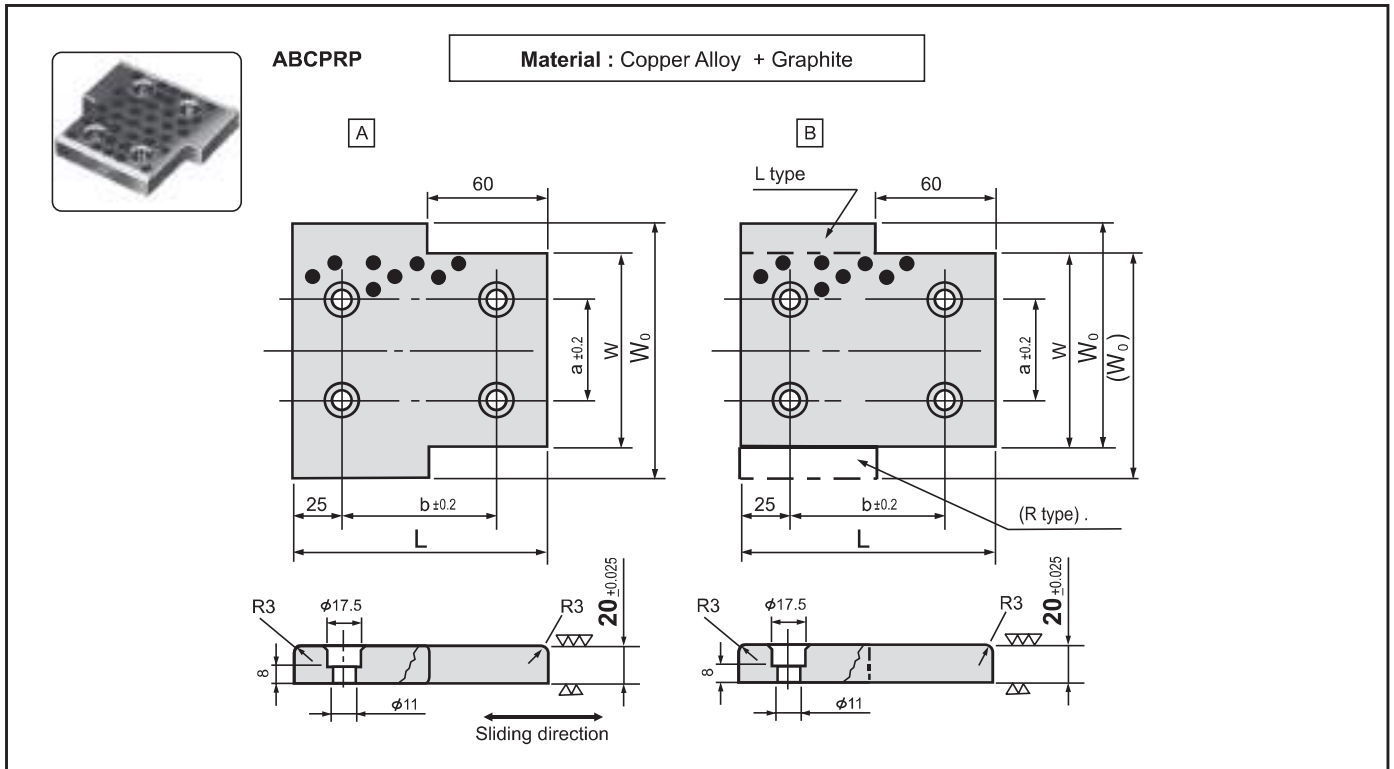

Standard No.	W	L	W <sub>0</sub>	a	b	Sketch
ABCPRP-100X125	100	125	130	50	75	A
ABCPRP-100X150		150			100	
ABCPRP-125X150	125	150	155	75	150	
ABCPRP-125X200		200			200	
ABCPRP-125X250		250			250	
ABCPRP-150X200	150	200	180	100	150	
ABCPRP-150X250		250			200	
ABCPRP-L(R)-100X125	100	125	115	50	75	B
ABCPRP-L(R)-100X150		150			100	
ABCPRP-L(R)-125X150	125	150	140	75	100	
ABCPRP-L(R)-125X200		200			150	
ABCPRP-L(R)-125X250		250			200	
ABCPRP-L(R)-150X200	150	200	165	100	150	
ABCPRP-L(R)-150X250		250			200	



ORDERING  
CODE

CATALOG NO.	W	L
ABCPRP	100	150
ABCPRP-L	100	150
ABCPRP-R	100	150

# Oilless Cam Positive Return Block



**ABCPRB  
ABCPRB-S**

<b>Material</b>	ABCPRB	Copper Alloy + Graphite
	ABCPRB-S	Copper Alloy

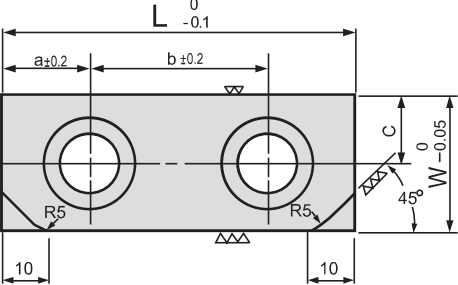

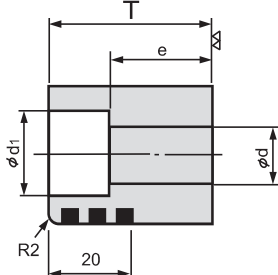

Graphite embedded area (ABCPRB)

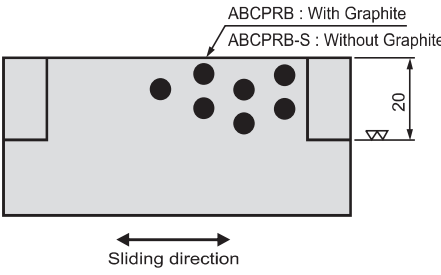

ABCPRB : With Graphite  
ABCPRB-S : Without Graphite

Sliding direction

Standard No.	W	L	T	a	b	c	φd	φd <sub>1</sub>	e
ABCPRB-25X60	25	60	30	15	30	11	11	17.5	18
ABCPRB-32X60	32	80	38	20	40	16	13	20	23
ABCPRB-32X80									
ABCPRB-25X60-S	25	60	30	15	30	11	11	17.5	18
ABCPRB-32X60-S	32	80	38	20	40	16	13	20	23
ABCPRB-32X80-S									



**ORDERING  
CODE**

<b>CATALOG NO.</b>	<b>W</b>	<b>L</b>
ABCPRB	32	60

# Cam positive return follower



**ASCPRF**

<b>Material</b>	Case hardening Steel
<b>Hardness</b>	56 - 60 Rc

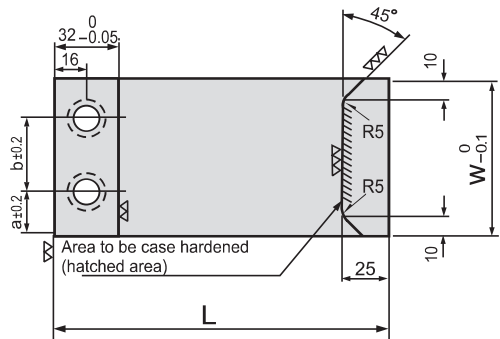

Area to be case hardened (hatched area)

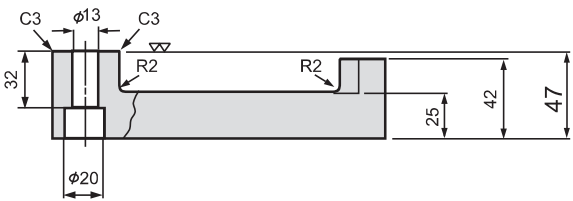

Standard No.	W	L	a	b
ASCPRF- 60X171	60	171	15	30
ASCPRF- 60X191		191		
ASCPRF- 80X171	80	171	20	40
ASCPRF- 80X191		191		



**ORDERING  
CODE**

<b>CATALOG NO.</b>	<b>W</b>	<b>L</b>
ASCPRF	60	171

# Cam Positive Return Follower



**ASCPRF-E**

<b>Material</b>	Case hardening Steel
<b>Hardness</b>	56 - 60 Rc

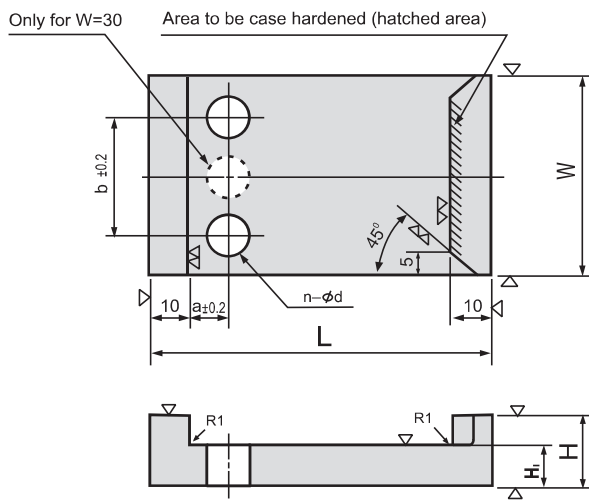

**ASCPRF-F**

<b>Material</b>	Case hardening Steel
<b>Hardness</b>	56 - 60 Rc

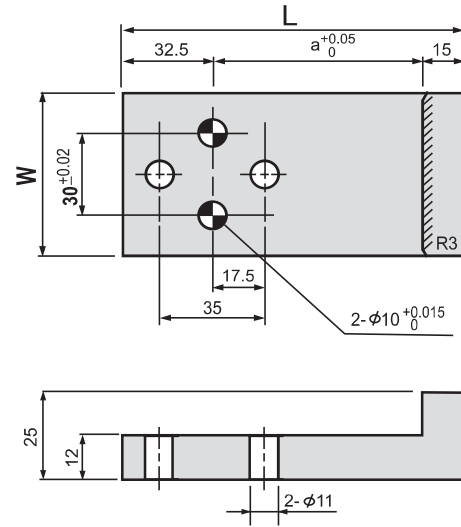

Standard No.	W	L	H	H1	a	b	φd	n
ASCPRF-E-30X 55	30	55	16	8	7.5	—	10	1
ASCPRF-E-30X 75		75						
ASCPRF-E-50X 65	50	65	18	10	10	30	12	2
ASCPRF-E-50X 85		85						
ASCPRF-E-50X105		105						
ASCPRF-E-80X 65	80	65	18	10	10	50	12	2
ASCPRF-E-80X 85		85						
ASCPRF-E-80X105		105						

Standard No.	W	L	a
ASCPRF-F- 60X100	60	100	52.5
ASCPRF-F- 60X120		120	72.5



**ORDERING CODE**

<b>CATALOG NO.</b>	<b>W</b>	<b>L</b>
ASCPRF-E	50	105



**ORDERING CODE**

<b>CATALOG NO.</b>	<b>W</b>	<b>L</b>
ASCPRF-F	60	100

# Oilless Cam Positive Return Plate/Follower



**ACKPZ**  
Cam positive return plate

**Material :** Copper Alloy + Graphite

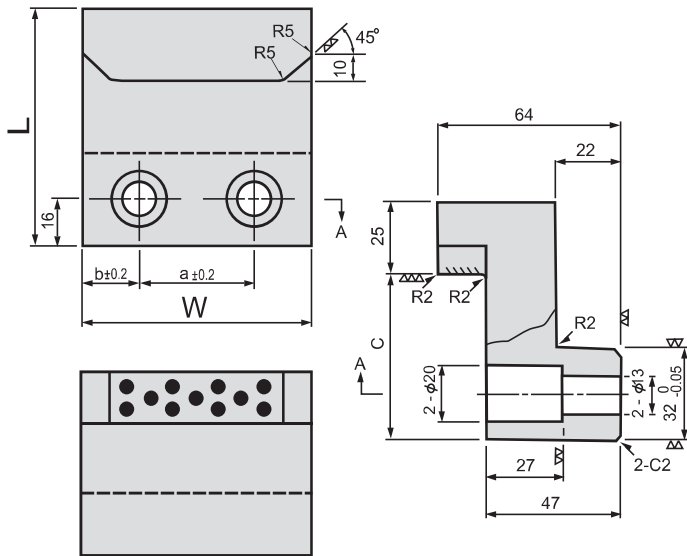

**ACKPL**  
**ACKPL-S**  
Cam positive return follower

<b>Material</b>	ACKPL	Copper Alloy + Graphite
	ACKPL-S	Case hardening steel (56 - 60 Rc)

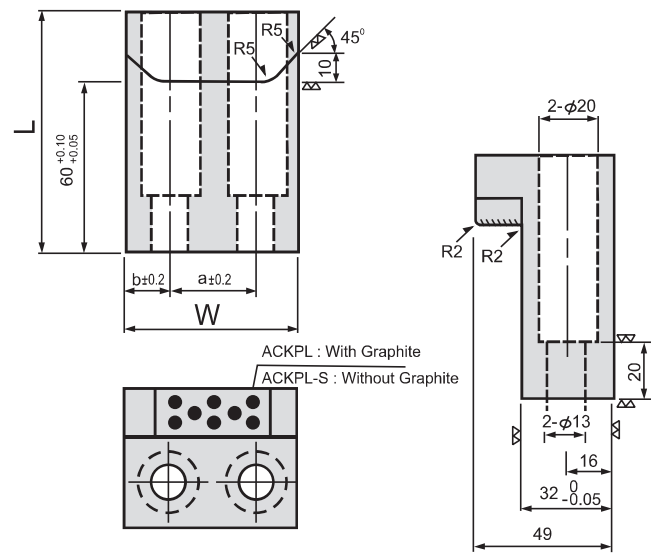

ACKPL : With Graphite  
ACKPL-S : Without Graphite

Standard No.	W	L	a	b	c
ACKPZ- 60X 82	60	82	30	15	57
ACKPZ- 60X102		102			77
ACKPZ- 60X112		112			87
ACKPZ- 80X 82	80	82	40	20	57
ACKPZ- 80X102		102			77
ACKPZ- 80X112		112			87

Standard No.	W	L	a	b
ACKPL- 60X85	60	85	30	15
ACKPL- 80X85	80		40	20
ACKPL- 60X85-S	60	85	30	15
ACKPL- 80X85-S	80		40	20



<b>ORDERING CODE</b>	<b>CATALOG NO.</b>	<b>W</b>	<b>L</b>
	ACKPZ	60	82



<b>ORDERING CODE</b>	<b>CATALOG NO.</b>	<b>W</b>	<b>L</b>
	ACKPL-S	60	85



# Oilless Arial Cam Center Upper

Case hardened steel is used as the base metal. This slide is embedded with special solid lubricants and is excellent in wear resistance. Use this plate together with ASCCB.



**ASCCU**

<b>Material</b>	Case hardening Steel + Graphite
<b>Hardness</b>	56 - 60 Rc

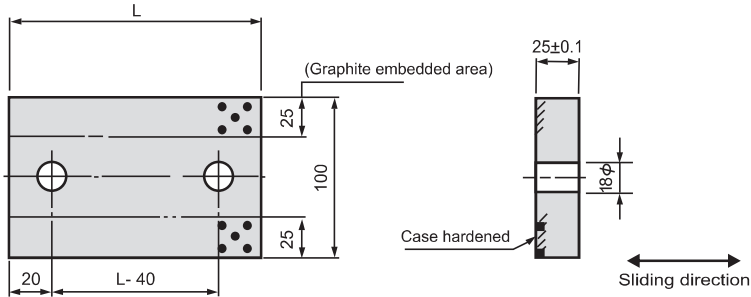

Standard No.	L
ASCCU-100	100
ASCCU-150	150



ORDERING CODE	CATLOG NO.	L
ASCCU	100	

# Arial cam center block



**ASCCB**

**Material : Mild Steel**

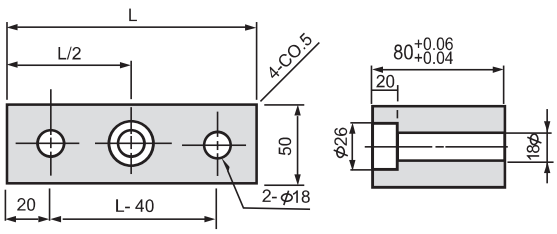

Standard No.	L
ASCCB-100	100
ASCCB-150	150



ORDERING CODE	CATLOG NO.	L
ASCCB	100	

# Oilless Guide Bar



ASGB

<b>Material</b>	Case hardening Steel + Graphite
<b>Hardness</b>	56 - 60 Rc

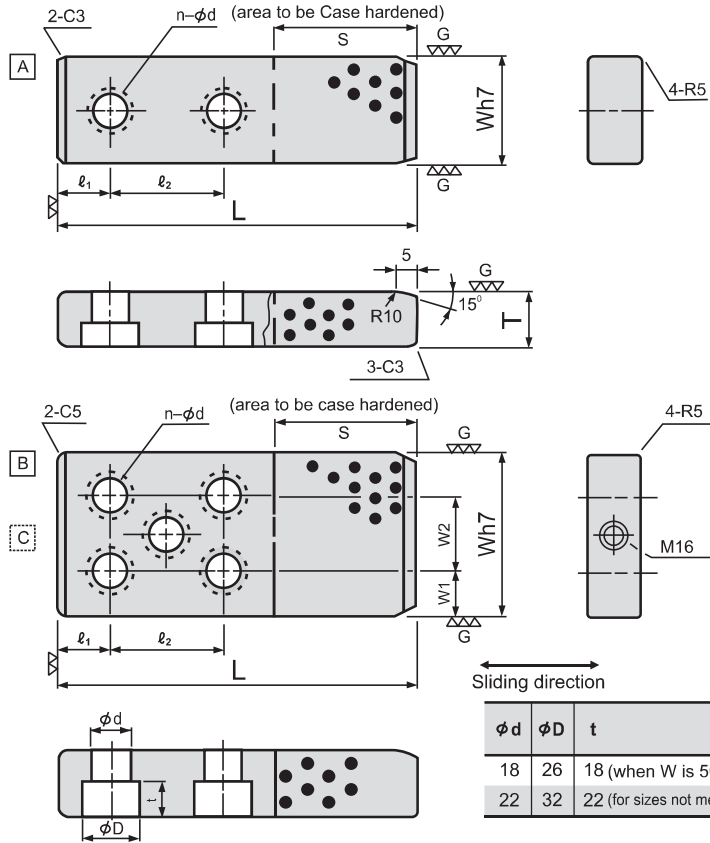

Standard No.	Wh7	L	T	S	$l_1$	$l_2$	w1	w2	Sketch	n
ASGB- 50X160	50 0 -0.025	160	30	60	20	50				
ASGB- 50X200		200		120						
ASGB- 50X260		260		80						
ASGB- 70X230	70 0 -0.030	230	35	100	25				A	2
ASGB- 70X260		260		60						
ASGB- 70X300		300		75						
ASGB- 70X350		350		150						
ASGB- 100X230	100 0 -0.035	230	45	100	30	60	20		B	5
ASGB- 100X280		280		160						
ASGB- 100X330		330		100						
ASGB- 100X390		390		120						
ASGB- 120X230		230		100						
ASGB- 120X280	280	160								
ASGB- 120X330	330	100								
ASGB- 120X390	390	200								
ASGB- 150X280	150 0 -0.040	280	50	160	30	60	30	90		
ASGB- 150X330		330		80						
ASGB- 150X390		390		140						
ASGB- 150X430		430		180						
ASGB- 180X280		280		160						
ASGB- 180X330	330	80								
ASGB- 180X390	390	140								
ASGB- 180X430	430	180								
ASGB- 180X480	480	200								
ASGB- 180X550	550	250								



ORDERING  
CODE

CATALOG NO. W L  
ASGB 150 280

# Oilless Guide Bar

Cast iron is used as the base metal with special lubricants embedded. This guide bar is used for the guide of upper and lower dies. The standard bar is designed to allow 10 mm difference in width for fool proofing.

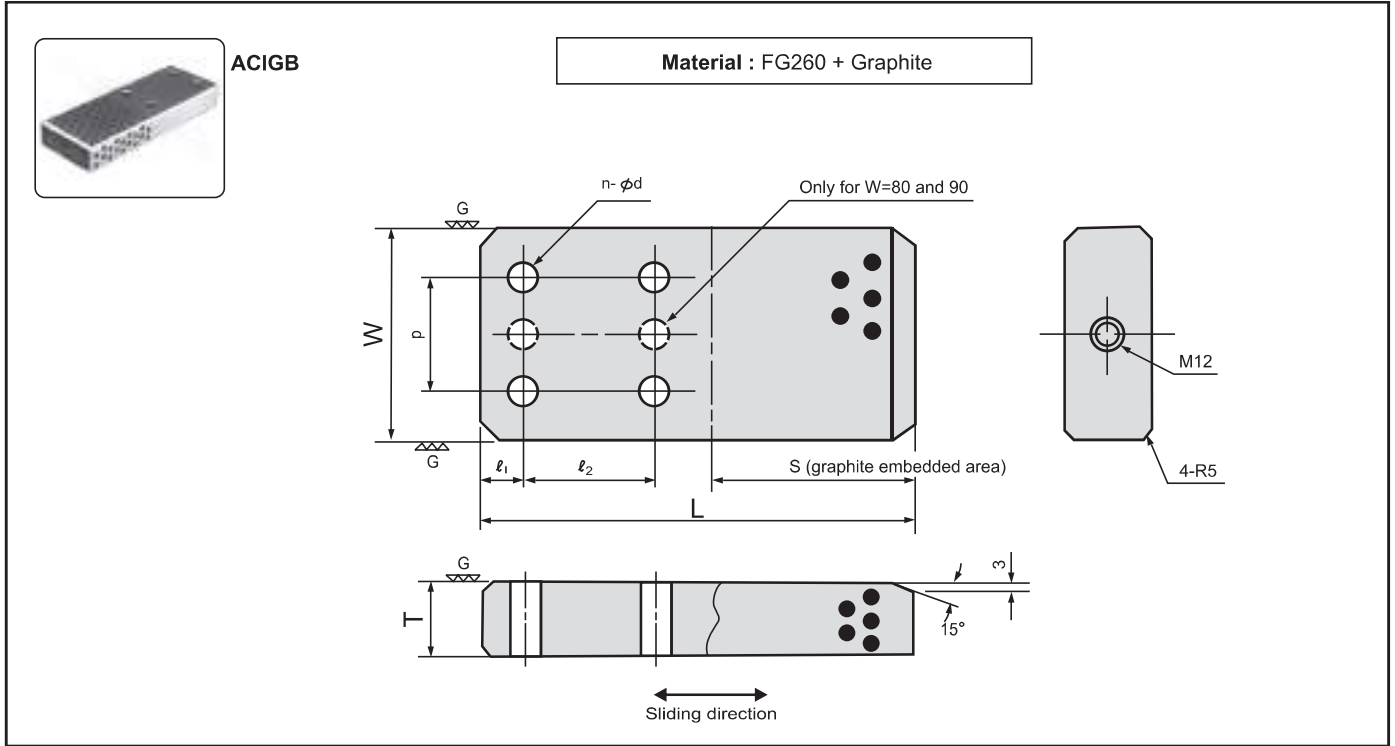

Standard No.	W Tolerance	L	T	S	ℓ1	ℓ2	p	n	φd
ACIGB- 80X220	80 0 -0.025	220	40	80	25	60	—	2	22
ACIGB- 80X260		260				70			
ACIGB- 80X300		300				80			
ACIGB- 120X280	120 0 -0.035	280	60	120	25	100	70	4	26
ACIGB- 120X340		340							
ACIGB- 120X380		380							
ACIGB- 150X340	150 0 -0.040	340	75	130	30	110	100	4	26
ACIGB- 150X380		380							
ACIGB- 150X430		430							
ACIGB- 180X340	180 0 -0.046	340	90	140	30	130	120	4	26
ACIGB- 180X380		380							
ACIGB- 180X430		430							
ACIGB- 90X220	90 0 -0.025	220	40	80	25	60	—	2	22
ACIGB- 90X260		260				70			
ACIGB- 90X300		300				80			
ACIGB- 130X280	130 0 -0.035	280	60	120	25	100	70	4	26
ACIGB- 130X340		340							
ACIGB- 130X380		380							
ACIGB- 160X340	160 0 -0.040	340	75	130	30	110	100	4	26
ACIGB- 160X380		380							
ACIGB- 160X430		430							
ACIGB- 190X340	190 0 -0.046	340	90	140	30	130	120	4	26
ACIGB- 190X380		380							
ACIGB- 190X430		430							



ORDERING CODE

CATALOG NO. W L  
ACIGB 150 340

# Oilless L Shaped Plate



**ABLSP**

**Material : Copper Alloy + Graphite**

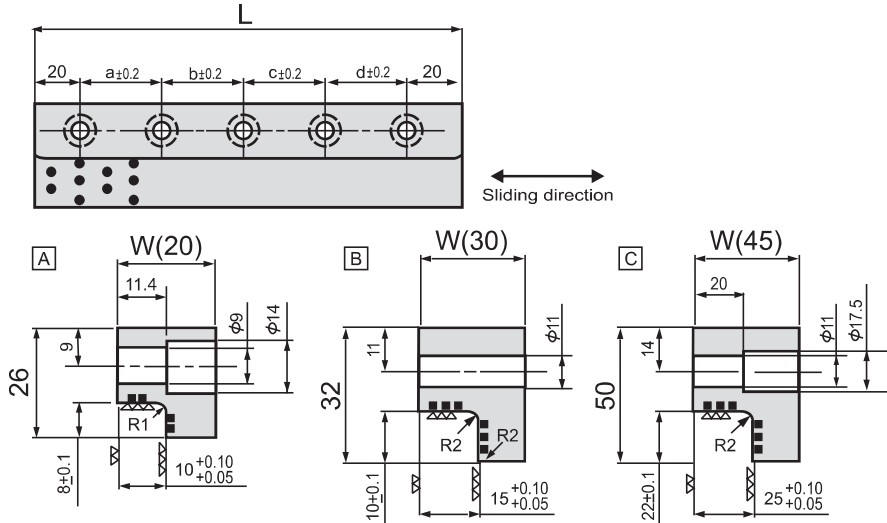

Standard No.	W	L	Bolt location				Bolt		Sketch
			a	b	c	d	Type	Q'ty	
ABLSP- 20X100	20	100	60	—	—	—	M 8	2	A
ABLSP- 20X150		150	55	55	—	—		3	
ABLSP- 20X200		200	55	50	55	—		4	
ABLSP- 30X100	30	100	60	—	—	—	M 10	2	B
ABLSP- 30X150		150	55	55	—	—		3	
ABLSP- 30X200		200	55	50	55	—		4	
ABLSP- 30X250		250	70	70	70	—		4	
ABLSP- 45X200	45	200	55	50	55	—	M 10	4	C
ABLSP- 45X250		250	70	70	70	—		4	
ABLSP- 45X300		300	65	65	65	65		5	
ABLSP- 45X350		350	80	75	75	80		5	



ORDERING CODE	CATALOG NO.	W	L
	ABLSP	30	150



# Oilless Slide Plate / Mini Plate

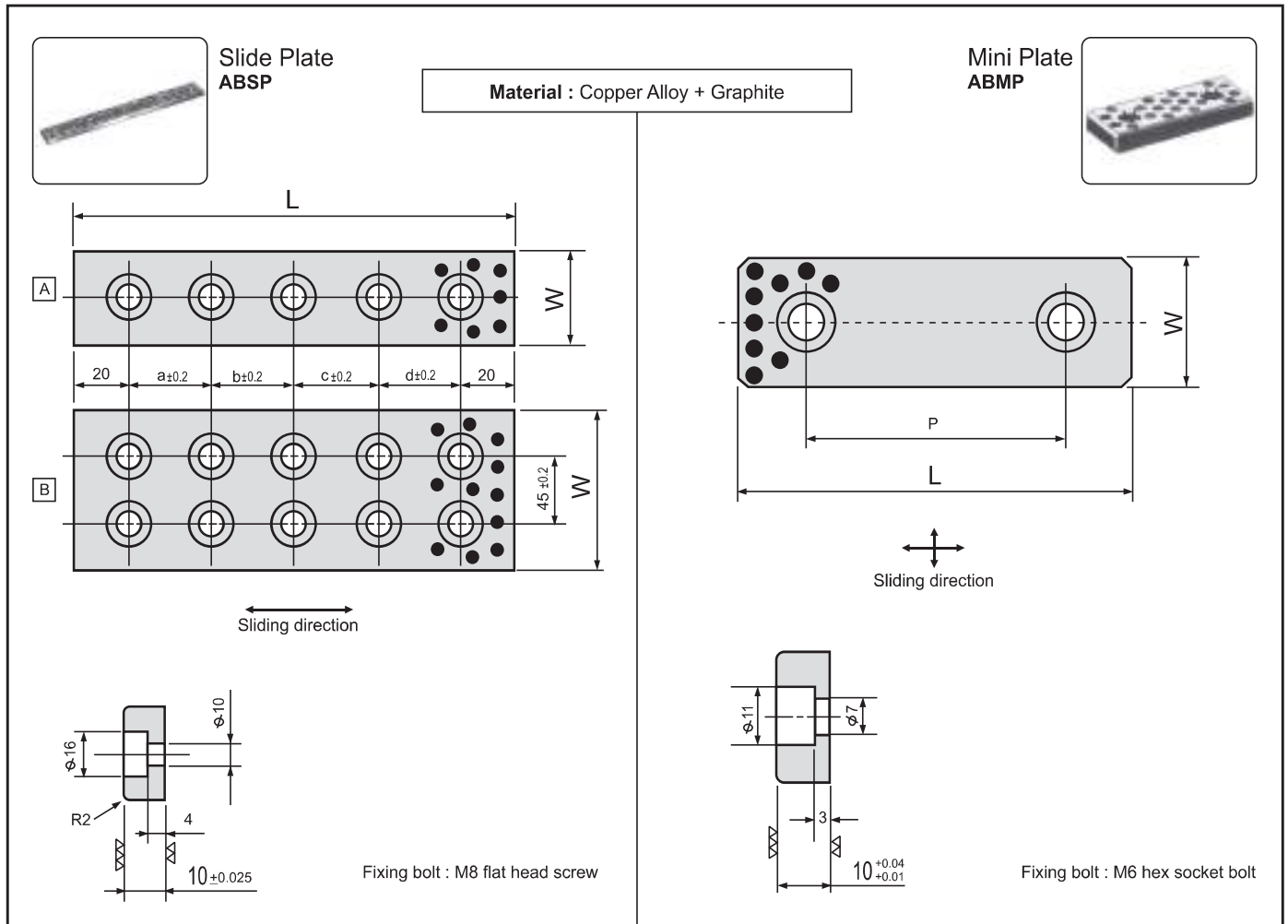

Standard No.	W	L	Bolt location				Bolt		Sketch
			a	b	c	d	Type	Q'ty	
ABSP- 35X100	35	100	60	—	—	—	M 8	2	A
ABSP- 35X150		150	55	55	—	—		3	
ABSP- 35X200		200	55	50	55	—		4	
ABSP- 35X250		250	70	70	70	—		4	
ABSP- 35X300		300	65	65	65	65		5	
ABSP- 35X350		350	80	75	75	80		5	
ABSP- 50X100	50	100	60	—	—	—	2	A	
ABSP- 50X150		150	55	55	—	—	3		
ABSP- 50X200		200	55	50	55	—	4		
ABSP- 50X250		250	70	70	70	—	4		
ABSP- 50X300		300	65	65	65	65	5		
ABSP- 50X350		350	80	75	75	80	5		
ABSP- 75X150	75	150	110	—	—	—	4	B	
ABSP- 75X200		200	80	80	—	—	6		
ABSP- 75X250		250	105	105	—	—	6		
ABSP- 75X300		300	85	90	85	—	8		
ABSP- 75X400		400	120	120	120	—	8		
ABSP- 75X500		500	115	115	115	115	10		

Standard No.	W	L	P
ABMP- 18X75	18	75	45
ABMP- 18X100		100	50
ABMP- 18X125		125	75
ABMP- 18X150	28	150	100
ABMP- 28X75		75	45
ABMP- 28X100		100	50
ABMP- 28X125	38	125	75
ABMP- 28X150		150	100
ABMP- 38X75		75	45
ABMP- 38X100	48	100	50
ABMP- 38X125		125	75
ABMP- 38X150		150	100
ABMP- 48X75	48	75	45
ABMP- 48X100		100	50
ABMP- 48X125		125	75
ABMP- 48X150		150	100



ORDERING  
CODE

CATALOG NO. W L  
ABSP 50 200



ORDERING  
CODE

CATALOG NO. W L  
ABMP 28 100

# Oilless High Pressure Plate



**ABHPP**

**Material : Copper Alloy + Graphite**

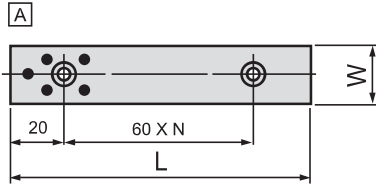

↕  
↔  
Sliding directions

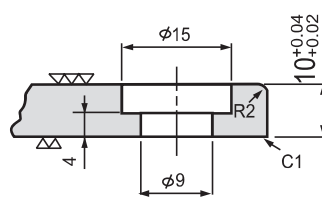
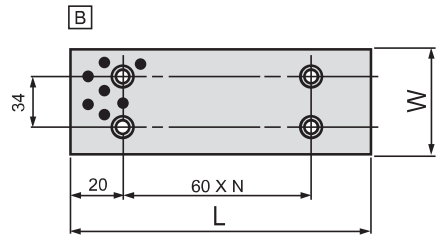

Standard No.	W	L	N	No. of holes	Sketch
ABHPP- 18X100	18	100	1	2	A
ABHPP- 18X160		160	2	3	
ABHPP- 18X220		220	3	4	
ABHPP- 28X100	28	100	1	2	
ABHPP- 28X160		160	2	3	
ABHPP- 28X220		220	3	4	
ABHPP- 38X100	38	100	1	2	
ABHPP- 38X160		160	2	3	
ABHPP- 38X220		220	3	4	
ABHPP- 48X100	48	100	1	2	
ABHPP- 48X160		160	2	3	
ABHPP- 48X220		220	3	4	
ABHPP- 58X100	58	100	1	4	B
ABHPP-58X160		160	2	6	
ABHPP- 58X220		220	3	8	
ABHPP- 68X100	68	100	1	4	
ABHPP- 68X160		160	2	6	
ABHPP- 68X220		220	3	8	



**ORDERING CODE**

**CATALOG NO. W L**  
ABHPP 48 100

# Oilless Guide Rail

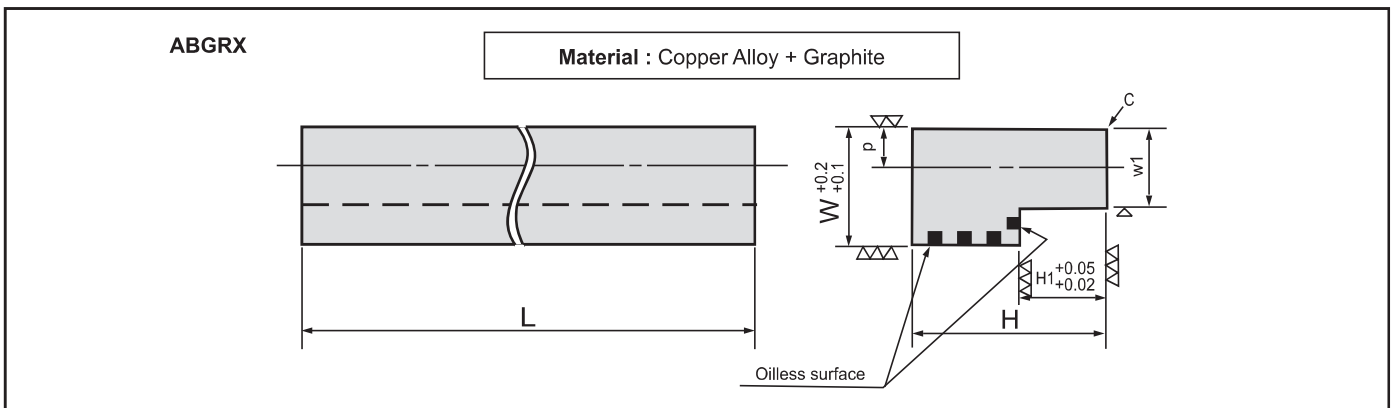
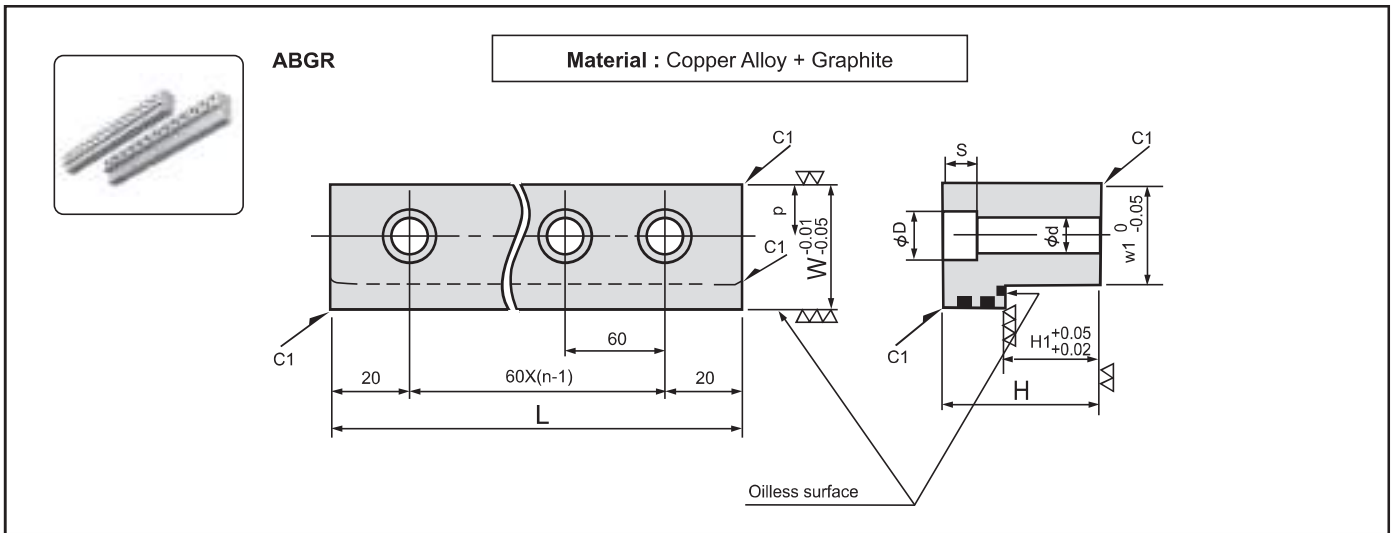

Standard No.	W	W1	L	H	H1	n	P	$\phi D$	$\phi d$	S
ABGR -100X30	23	15	100	30	15	2	7.5	11	7	7
ABGR -160X30			160			3				
ABGR -220X30			220			4				
ABGR -100X41			100	2						
ABGR -160X41	23	15	160	41	26	3	7.5	11	7	7
ABGR -220X41			220			4				
ABGR -100X25			100			2				
ABGR -160X25	28	20	160	25	10	3				
ABGR -220X25			220			4				
ABGR -100X35			100			2				
ABGR -160X35			160	3						
ABGR -220X35	28	20	220	35	15	4	10	14	9	10
ABGR -100X56			100			2				
ABGR -160X56			160			3				
ABGR -220X56			220	4						

Standard No.	W	W1	H	H1	L	Recommended Bolt		
						p	Size	
ABGRX -20X15	20	14.5	15	5	320	8	M8	
ABGRX -20X20			20					
ABGRX -20X25			25					
ABGRX -20X23			23					
ABGRX -20X28	28	8	10	M8				
ABGRX -25X28	28							
ABGRX -25X33	25	17.5				33		
ABGRX -25X43						43		
ABGRX -30X38	30	19			38	15	10	M8
ABGRX -30X43					43			
ABGRX -30X53					53			
ABGRX -35X43					43			
ABGRX -35X53	35	23	53	15	12	M10		
ABGRX -35X63			63					
ABGRX -40X45			45					
ABGRX -40X55	40	28	55	20	14	M12		
ABGRX -40X65			65					



ORDERING CODE

CATALOG NO. W L  
ABGR 28 100



ORDERING CODE

CATALOG NO. W H  
ABGRX 30 38

# Oilless Guide Rail For Plastic Molding

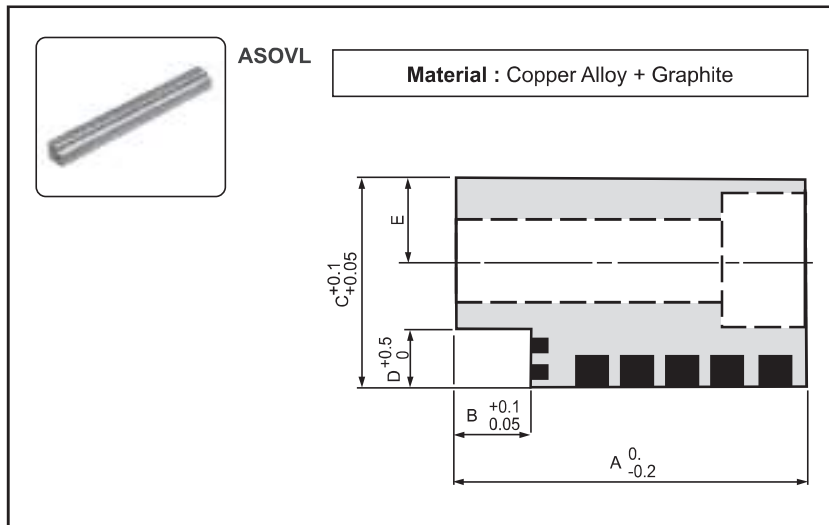

Standard No.	A	B	C	D	E
ASOVL - 0X205	12	5	15	5	6
ASOVL - 1X205	17	7	20		7.5
ASOVL - 1X320				22	28
ASOVL - 2X205	27	10	28		
ASOVL - 2X320				36	10
ASOVL - 3X205	46	22	40		
ASOVL - 3X320				66	22
ASOVL - 4X205	(56)	26	40		
ASOVL - 4X320				86	26
ASOVL - 5X205	(76)	26	40		
ASOVL - 5X320					
ASOVL - 6X205					
ASOVL - 6X320					
ASOVL - 7X205					
ASOVL - 7X320					

Example : ASOVL - 0 X 205 (L size ) bolt holes are not machined.



ORDERING CODE

CATALOG NO.  
ASOVL-4x205

# Oilless L-type liner plate

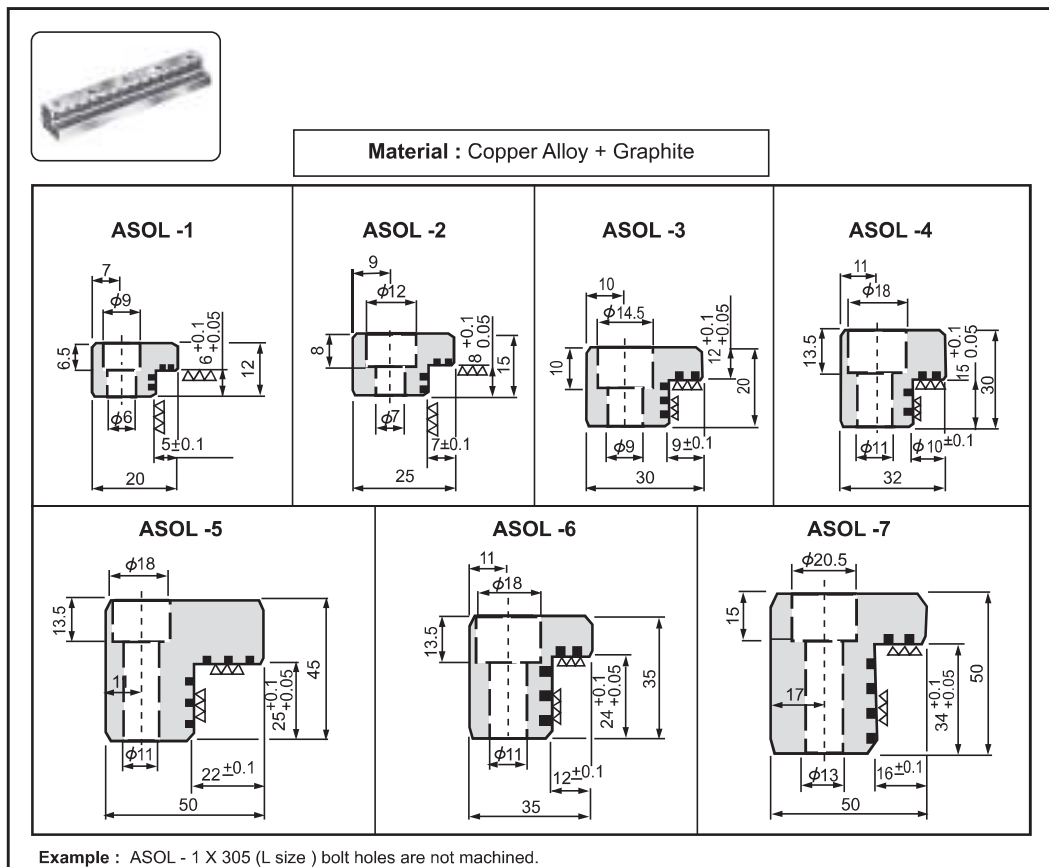

Example : ASOL - 1 X 305 (L size ) bolt holes are not machined.

Standard No.
ASOL - 1X305
ASOL - 2X305
ASOL - 3X305
ASOL - 4X605
ASOL - 5X605
ASOL - 6X605
ASOL - 7X605



ORDERING CODE

CATALOG NO.  
ASOL - 5



# Oilless Slide Inclined Pin Holders For Loose Core - Fixed Type

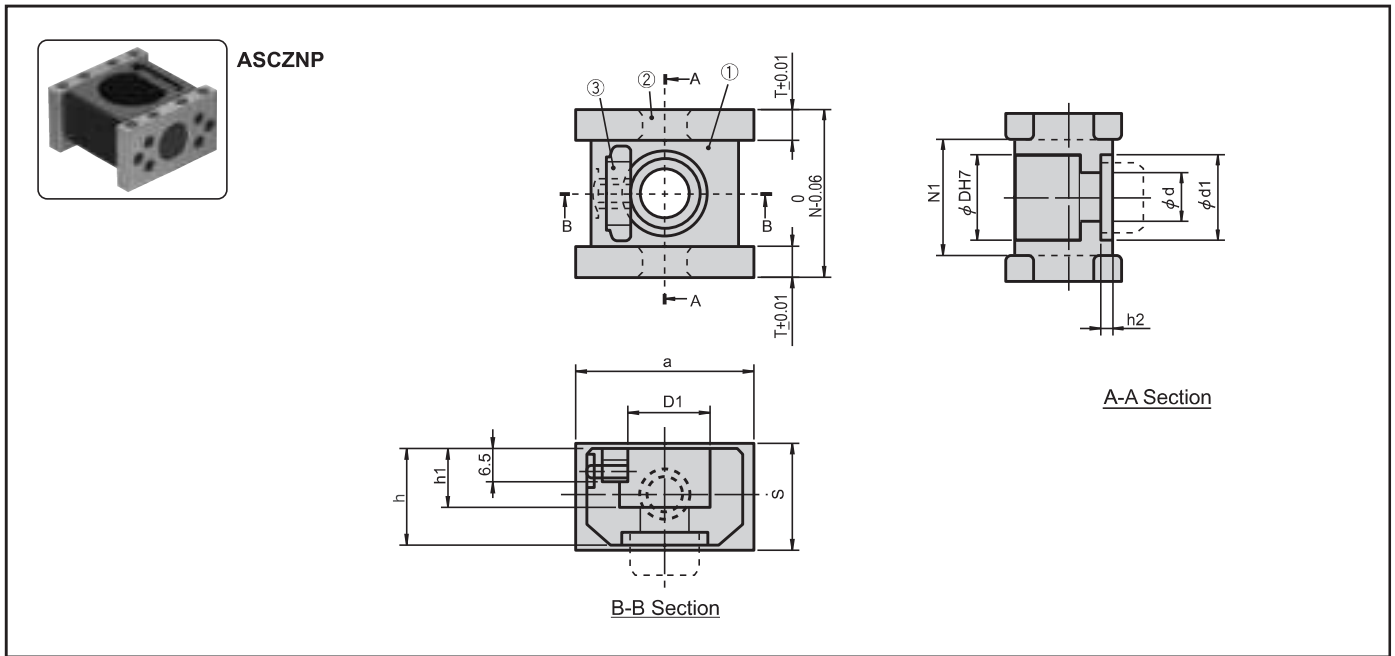

Item	Components	Parts Name	M	Piece
①	Inclined pin holder	Inclined pin holder	C45	1
②	Slide plate	Slide plate	Copper alloy + Graphite	2
③	Key	Key	C45	1

## ■ Fixed type

Catalog Number		① Inclined pin holder								② Slide plate		
Type	D	D1	d	d1	h	h1	h2	N	N1	S	a	T
ASCZNP	12	11	5.5	-	16	10	-	30	17	20	35	6.5
	16	15	9	16	18	11	3	33	20	20	40	6.5
	20	18	11	20	22	13	5.5	38	25	24	40	6.5
	25	22	11	20	26	15	5.5	45	31	26	45	7
	30	27.5	11	20	30	17	3.5	51	36	30	55	7.5



ORDERING  
CODE

CATALOG NO.  
ASCZNP 12

# Oilless Heel Guide Plates



**ASHGP**  
**ASHGPZ**  
(C'bore type)

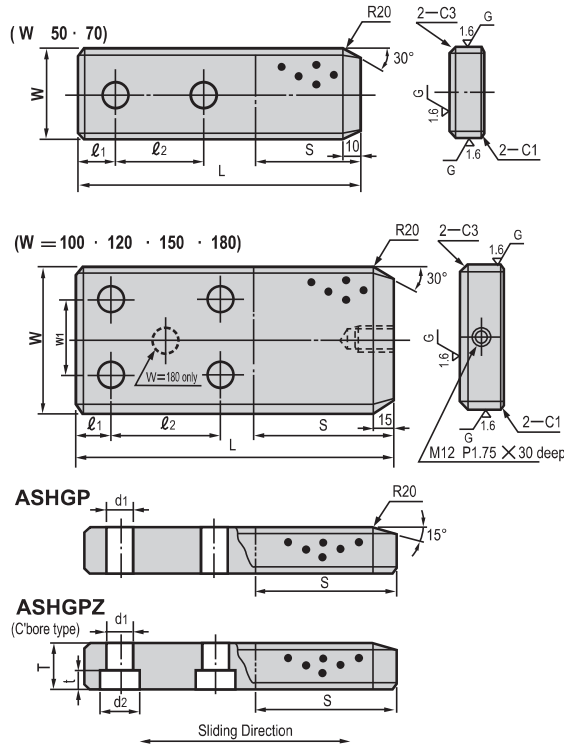

- M** Case Hardening Steel
- Graphite (embedded)
- Slide parts (S)
- H** 55 - 58 HRC ~ (case hardening)

Note : Do initial greasing before use.

W	T	S	l <sub>1</sub>	l <sub>2</sub>	w <sub>1</sub>	d <sub>1</sub>	d <sub>2</sub>	t	Catalog No.					
									Type	L				
50	0 -0.025	30	60	50	—	18	26	18	ASHGP ASHGPZ	50	160			
			120	20							200			
			120	80							260			
70	0 -0.030	35	100	60	—	18	26	18		ASHGP ASHGPZ	70	230		
			160	25								260		
			160	75								300		
100	0 -0.035	45	150	150	—	18	26	18			ASHGP ASHGPZ	100	350	
			100	60									230	
			160	30									280	
120	0 -0.035	45	200	120	60	18	26	18				ASHGP ASHGPZ	120	330
			100	60										280
			160	30										330
150	0 -0.040	50	200	120	60	22	32	22	ASHGP ASHGPZ				150	390
			160	60										280
			190	30										330
180	0 -0.040	55	190	180	120	22	32	22		ASHGP ASHGPZ			180	430
			160	60										280
			190	30										330
			200	200										480
			250	225										550



ORDERING CODE    CATALOG NO.    L  
ASHGP 120    280

# Heel Guide Plates With Oil Groove



**ASHGPG**  
**ASHGPGZ**  
(C bore type)

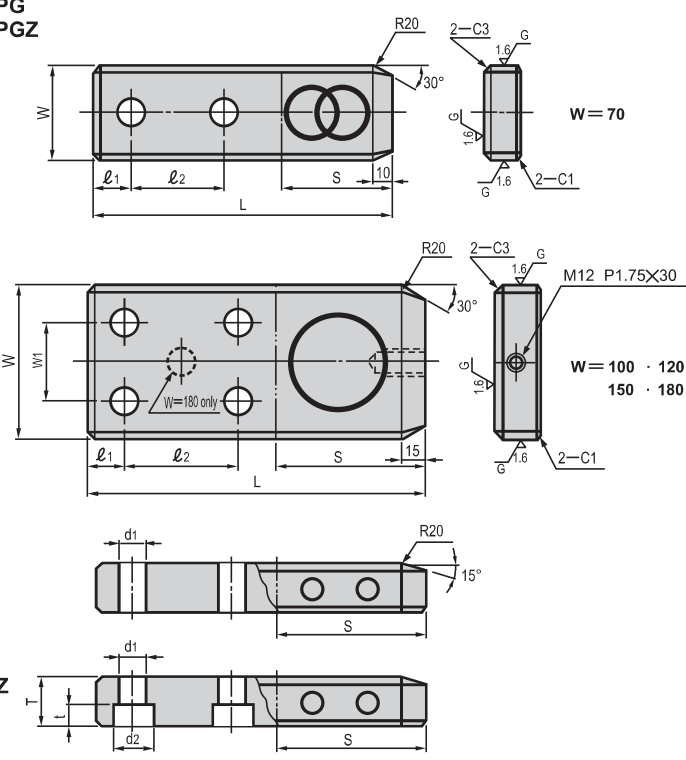

Oil groove details

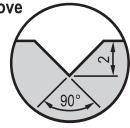

Front

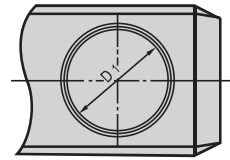

Side

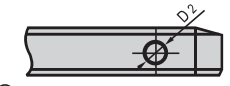

ⓘ The diameters and positions of oil grooves are different depending on the size.

**M** Material : Case Hardening Steel  
**H** Hardness : 55 - 60 HRC

W	T	S	l <sub>1</sub>	l <sub>2</sub>	w <sub>1</sub>	d <sub>1</sub>	ASHGPGZ		Oil groove				Catalog No.		
							d <sub>2</sub>	t	Front		Side		Type	W	L
									Q'ty	D <sub>1</sub>	Q'ty	D <sub>2</sub>			
70	0 -0.030	35	100	25	—	18	26	18	2	50	each2	20	ASHGPG ASHGPGZ	70	230
									2	50	each3	20			260
									2	50	each3	20			300
100	0 -0.035	45	100	30	60	—	—	—	1	63	each2	20		100	230
									2	63	each3	20			280
									2	63	each3	20			330
120	0 -0.035	45	160	30	60	—	—	—	2	50	each2	20		120	230
									4	50	each3	20			280
									4	50	each4	20			330
150	0 -0.035	50	160	30	60	90	22	32	22	4	50	each3	20	150	280
										4	63	each3	20		330
										5	50	each4	20		390
180	0 -0.040	55	160	30	60	120	—	—	—	5	50	each3	20	180	280
										5	50	each4	20		330
										5	50	each4	20		390
			190		180										430



ORDERING  
CODE

CATALOG NO.	L
ASHGPGZ180	280

# Oilless Heel Guide Plates



**ASHGPP  
ASHGPZZ**

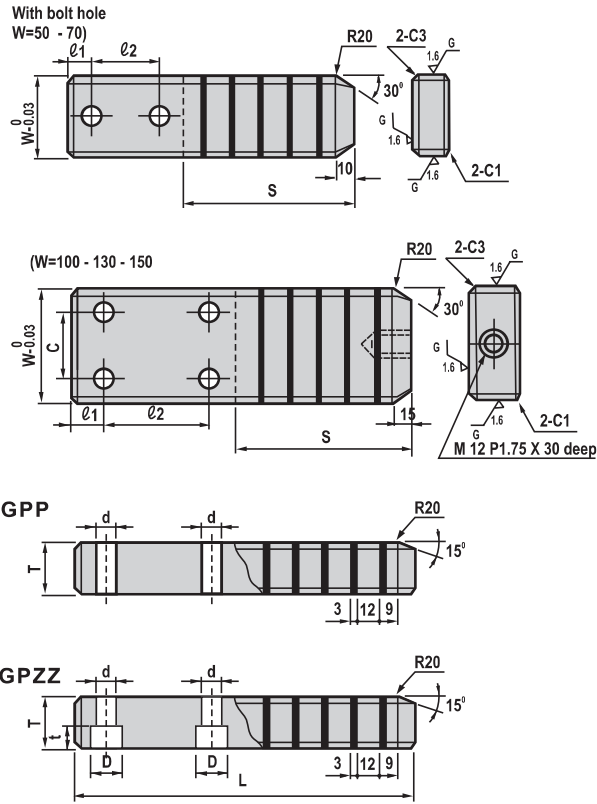

**M** Case Hardened Steel  
Graphite (Embedded)  
**H** 55HRC

T	l1	l2	C	d	D	t	Grooves	S	Catalog No.		L
									Type	w	
30	20	50	—	18	26	18	3	60	<b>ASHGPP ASHGPZZ</b>	50	160
							5	90			190
							7	120			220
35	25	60	—	18	26	18	6	100		70	230
							9	140			270
							11	180			310
45	30	90	60	18	26	18	8	130		100	300
							11	180			350
							14	230			400
50	30	120	80	22	26	18	9	150		130	350
							12	200			400
							16	250			450
60	35	150	100	22	26	18	11	180		150	420
							14	230			470
							18	280			520



**ORDERING CODE**    **CATALOG NO.**    L  
ASHGPZZ 130    350

# Heel Guide Plates with Oil Groove



ASHGPOGA  
ASHGPOGB

With bolt hole  
(W=50 - 70)

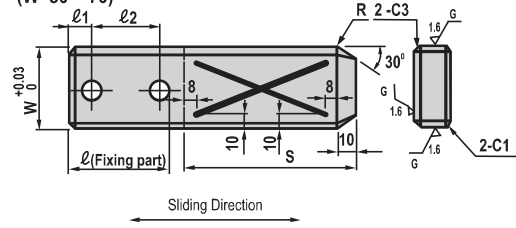

(W=100 - 130 - 150 - 180)

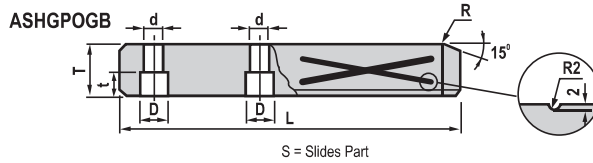
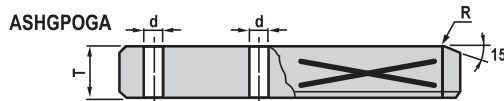
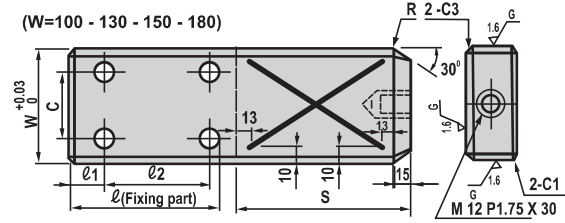

S = Slides Part

**M** Material : Case Hardening Steel  
**H** Hardness : 55 - 60 HRC

T	l	l <sub>1</sub>	l <sub>2</sub>	C	d	D	t	Catalog No.		S	L 10 mm increments
								Type	W		
30	90	20	50	—	18	26	18	ASHGPOGA	50	60	150 ~ 180
										90	190 ~ 250
35	110	25	60	—	18	26	18		70	90	200 ~ 250
										120	230 ~ 350
45	150	30	90	60	22	32	22		100	120	270 ~ 320
										180	330 ~ 400
50	150	30	90	80	22	32	22	130	150	300 ~ 380	
			120						390 ~ 500		
60	160	35	90	100	22	32	22	150	180	340 ~ 450	
			150						460 ~ 550		
			180						380 ~ 470		



ORDERING  
CODE

CATALOG NO.	S	L
ASHGPOGA 150	180	350

# Guide Bar - Wear Plate Type



**AGBTP**  
(Copper Alloy + Graphite Plate Type)  
**AGBTS**  
(Case Hardening Steel + Graphite Plate Type)

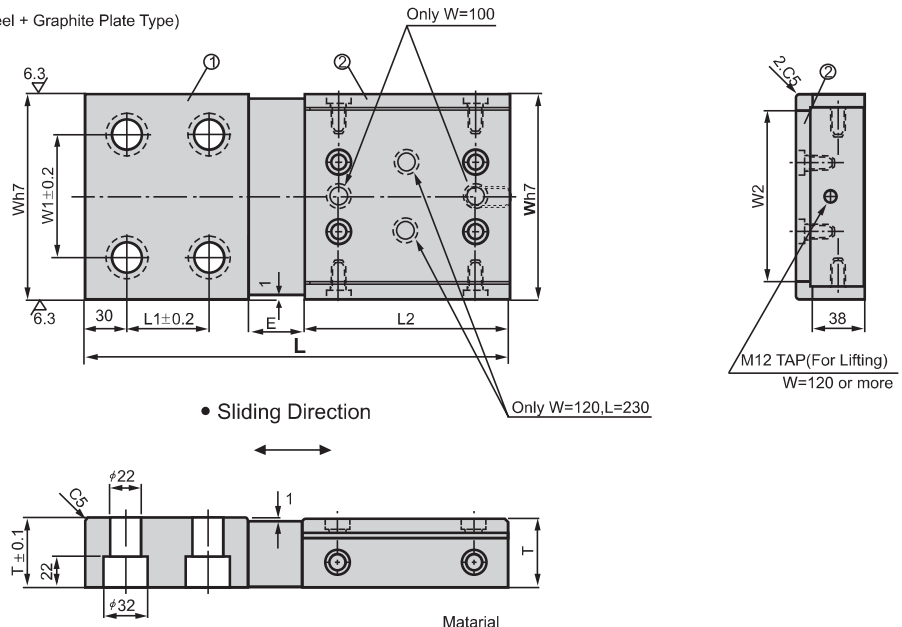

Material  
 ① Guide bar body M.S.  
 ② AGBTP Copper Alloy with graphite (ABTWP)  
 AGBTS CHDN steel with graphite (ASTWP)

W h 7	W 1	W 2	L 1	L 2	T	E	② Mounting Bolt Quantity	Catalog No.	W	L	
100	0 -0.035	60	75	60	75	45	6	AGBTP AGBTS	100	230	
				100	125					280	
			120	150	330						
			120	150	390						
120	0 -0.035	100	100	60	75	50	8		AGBTP AGBTS	120	230
				100	125						280
			120	150	330						
			120	150	390						
150	0 -0.040	90	125	60	125	50	8	AGBTP AGBTS		150	280
				100	125						330
			120	150	390						
			140	150	430						



ORDERING CODE

CATALOG NO.	W	L
AGBTP	100	280
AGBTS	120	390



**ASK**  
(Without Oilgroove)

**ASKZ**  
(With Oilgroove)

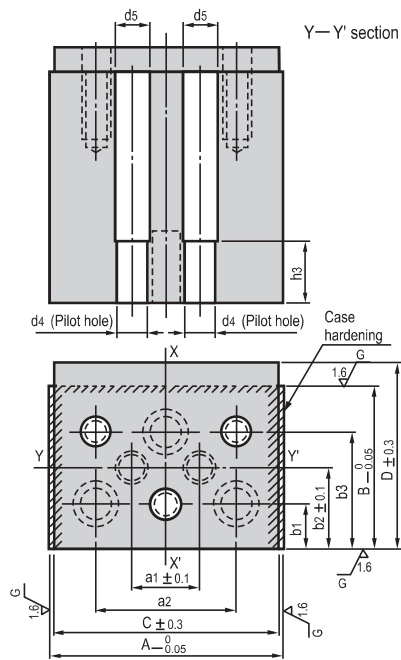

A	ASK80 ASKZ80	ASK100 ASKZ100
③	T=10 M10-30 3Pc.	M12-35 3Pc.
	T=15 M10-35 3Pc.	M12-40 3Pc.
	T=20 -	M12-45 3Pc.
④	M10-50 3Pc.	M12-55 3Pc.
⑤	AITHDP10-40 2Pc.	AITHDP13 50 2Pc.

① No accessories attached for ASKP (plate only).

- ① M Case Hardened Steel
- H 40 ~ 45 HRC (Case Hardening)
- ② M EN8

① Installation block													② Plate							
A	B	a1	a2	b1	b2	b3	d1	d2	d3	d4	h1	h2	h3	M×P	C	D	a2	b1	b3	d5
80	60	25	50	15	30	45	11	18	11	9.8	25	30	20	10×1.5	76	75	50	15	45	12
100	70	30	60	20	35	50	13	20	13	12.8	30	30	25	12×1.75	96	85	60	20	50	15

Catalog No.		H		T
Type	A	50	60	
ASK	80			10
		70	80	15
			120	
ASKZ (① ~ ⑤)	100	60		10
		70	80	15
			100	20
			120	20

Catalog No.		T
Type	A	
ASKP (② Only)	80	10
		15
	100	10
		15
		20



ORDERING CODE	CATALOG NO.	H	T
	ASK100	60	10
	ASKP100		10

# Pad Guide Block



**ASPGB**  
(Without oil groove)

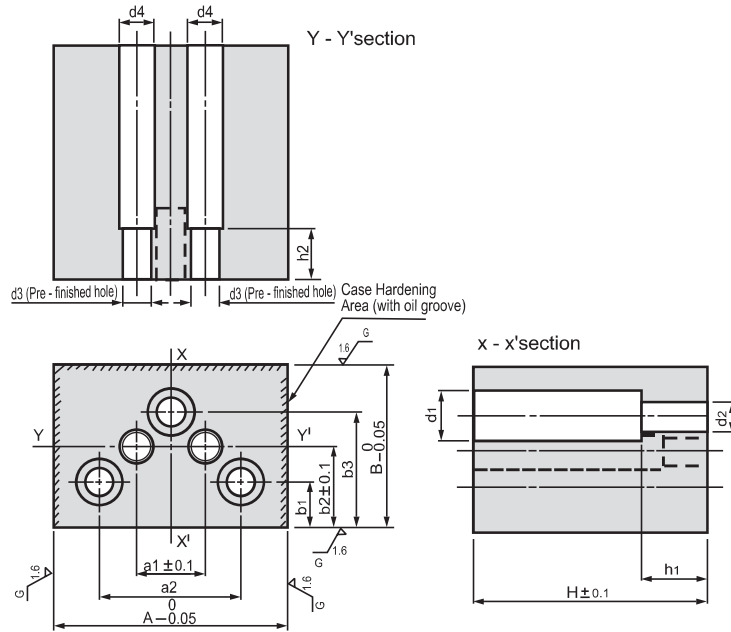

**M** Case Hardening Steel  
**H** 40-45HRC

A	B	a1	a2	b1	b2	b3	d1	d2	d3	d4	h1	h2	Catalog No.		H
													Type	A	
80	60	25	50	15	30	45	18	11	9.8	12	30	20	ASPGB	80	50 60
															70 80 100
															120
100	70	30	60	20	35	50	20	13	12.8	15	30	25	ASPGB	100	60
															70 80 100
															120



ORDERING  
CODE

CATALOG NO.	A	H
ASPGB	80	60



# Pad Guide Block - Center Guide Type with Keeper Plate

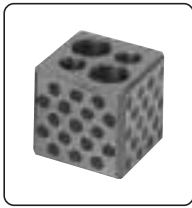

**APGBAK**  
(Dowel Pin Hole Finished - FG260 Type)

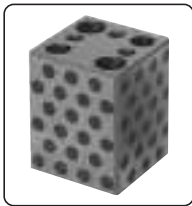

**APGBSK**  
(Dowel Pin Hole Finished - S45C Type)

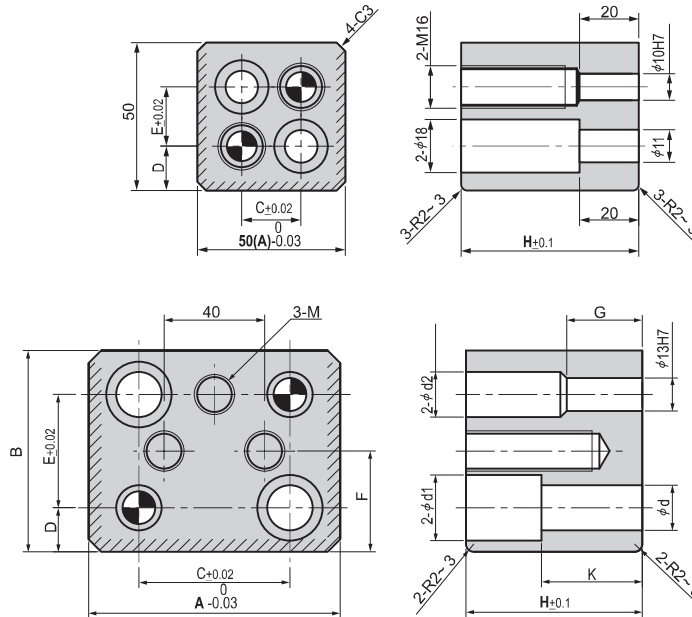

**Material**  
**APGBAK** FG260  
**APGBSK** S45C with Graphite  
 (Hatched Area)

B	C	D	E	F	G	K	d	d <sub>1</sub>	d <sub>2</sub>	M	Catalog No.	A	H
50	20	15	20	—	—	—	—	—	—	—	APGBAK APGBSK	50	50 60 90
70	40	15	40	35	25	30	13	20	16	M12		70	70 90
80	60	17.5	45	40	30	40	18	26	18	M16		100	70 90 130*

\*H= 130 is APGBSK only.



ORDERING  
CODE

CATALOG NO.	A	H
APGBAK	50	60
APGBSK	100	90

# Pad Guide Block - Centre Guide Type With Keeper Plate

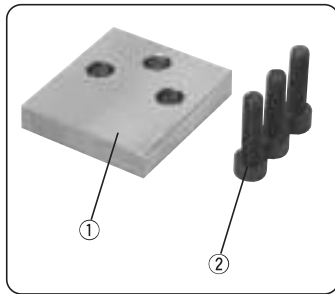

**AKPLT**  
(Single-Surface Type)

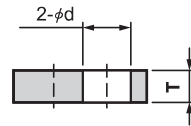
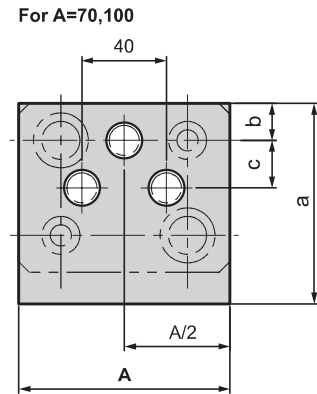
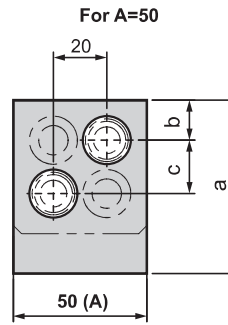

**AKPLTT**  
(Three-Surface Type)

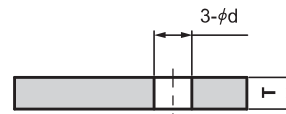
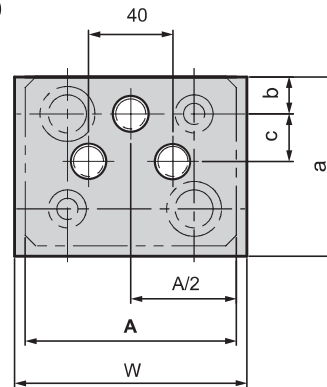

Material ① S45C  
② SCM435

d	② Attached bolt	a	b	c	Catalog No.	A	T
18	M 16 X 50	65	15	20	AKPLT	50	12
13	M 12 X 40	85	15	20		70	
17	M 16 X 50	95	17.5	22.5		100	

d	② Attached bolt	W	a	b	c	Catalog No.	A	T
13	M 12 X 40	80	75	15	20	AKPLTT	70	15
18	M 16 X 50	110	85	17.5	22.5		100	



ORDERING  
CODE

CATALOG NO.	A	T
AKPLT	70	15